



FLOODLIGHTS



INSTRUCTION MANUAL

**IMPORTANT: PLEASE READ THESE INSTRUCTION BEFORE
USING THE PRODUCT AND RETAIN FOR FUTURE USE.**

IMPORTANT SAFETY INSTRUCTIONS

The following should always be observed for safety

- 1 Ensure the power is turned off before starting the installation.
- 2 The light source of this luminaries is not replaceable, when the light source reaches its end of life the whole luminaire should be replaced.
- 3 Proper grounding should be ensured throughout the installation.
- 4 Installation must be performed by a qualified electrician.
- 5 Keep the product out of the reach of children and pets. This product is not intended for use by children.
- 6 Do not operate if the product has been dropped or damaged in any way. Please seek help from a professional service facility for electrical or mechanical adjustment, or repair.
- 7 Do not touch the floodlight when in operation or shortly after use as the product can get hot and there is a risk of being burnt.
- 8 Connect the floodlight to the rated supply voltage only.
- 9 Do not cover the product.
- 10 Do not install on to flammable surfaces.
- 11 Must be connected to an Earth.
- 12 The external flexible cable of the product cannot be replaced, if damaged the light should be scrapped.
- 13 Do not use in temperatures over 40°C or below – 20°C.
- 14 Do not look directly at the light.
- 15 The product is non-dimmable.
- 16 Condensation can form on the inside of the glass diffuser during rainy or foggy weather, this is normal.
- 17 All connections must be waterproof to avoid capillary action.
- 18 Do not disassemble the floodlight or remove the cover during operation.
- 19 The PIR floodlight should be installed at a height of 3m under the eaves.

PRODUCT OVERVIEW

Screwless Terminal Connector: Simplifies installation by allowing cables to be terminated directly within the fitting, eliminating the need for a separate junction box and reducing installation time.

Weather Resistance: Designed to withstand harsh outdoor conditions, offering protection against dust and water, ensuring reliable performance year-round.

Discreet LED Design: Features LED chips that remain hidden when switched off, maintaining a sleek and unobtrusive appearance that blends seamlessly into any outdoor environment.

Sustainable Construction: Crafted with 20% recycled materials, reflecting our commitment to reducing environmental impact while maintaining high performance.

Long-lasting Performance: Features an LED lifetime of 30,000 hours, offering durable and dependable illumination over an extended period.

Eco-Friendly and Efficient Lighting Solution: Combines energy efficiency, sustainability, and high-performance lighting, making it an ideal choice for environmentally conscious consumers.

TECHNICAL DATA

Watt	Voltage	Lumen (LED)	IP	DF	IK	CRI	Energy rating	Operation Temp.	Lifetime	Guarantee	Sensor
10W	220-240V	1600	65	0.5	05	>70Ra	C	~20°C-40°C	30,000	1 year	No
20W	220-240V	3200	65	0.7	05	>70Ra	C	~20°C-40°C	30,000	1 year	No
30W	220-240V	4800	65	0.9	05	>70Ra	C	~20°C-40°C	30,000	1 year	No
50W	220-240V	8000	65	0.9	05	>70Ra	C	~20°C-40°C	30,000	1 year	No
10W PIR	220-240V	1600	44	0.5	05	>70Ra	C	~20°C-40°C	30,000	1 year	PIR
20W PIR	220-240V	3200	44	0.7	05	>70Ra	C	~20°C-40°C	30,000	1 year	PIR
30W PIR	220-240V	4800	44	0.9	05	>70Ra	C	~20°C-40°C	30,000	1 year	PIR
50W PIR	220-240V	8000	44	0.9	05	>70Ra	C	~20°C-40°C	30,000	1 year	PIR

INSTALLATION

CONNECTING THE FLOODLIGHT TO THE MAINS SUPPLY

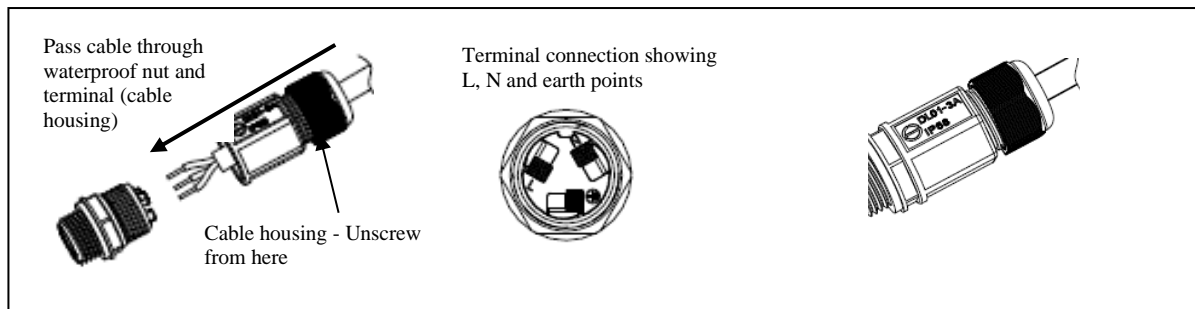

- 1 Unscrew the terminal by loosening from the point as indicated above. Pass the cable wires through the waterproof nut and terminal.
- 2 Connect the wires to the L, N and Earth terminals as indicated on the terminal connection. The brown cable is connected to the live input (L), the blue wire connects to the neutral input (N), and the yellow and green one to grounding input. After connecting the relevant wires, use insulation tape and waterproof tape to insulate and waterproof the input cable. A professional waterproof junction box is recommended.
- 3 Complete the link by screwing the wired terminal connection to the cable housing ensuring a tight connection.

MOUNTING THE FLOODLIGHT

- 1 Lineup the bracket on the wall and mark the location of the screw holes.
- 2 Drill holes in the building surface with a hammer drill.
- 3 Insert the expansion screws.
- 4 Using the screws supplied, fix the floodlight bracket into position.
- 5 Adjust the angle of the floodlight and tighten the screws either side of the bracket.
- 6 Connect the wire into the screwless cap. Unscrew the screwless cap as shown to reveal the wire input points. Place wire through the first part of the cap. Then place the individual wires into relevant input points. The brown cable is connected to the live input (L), the blue wire connects to the neutral input (N), and the yellow and green one to grounding input. After connecting the relevant wires, use insulation tape and waterproof tape to insulate and waterproof the input cable. A professional waterproof junction box is recommended.

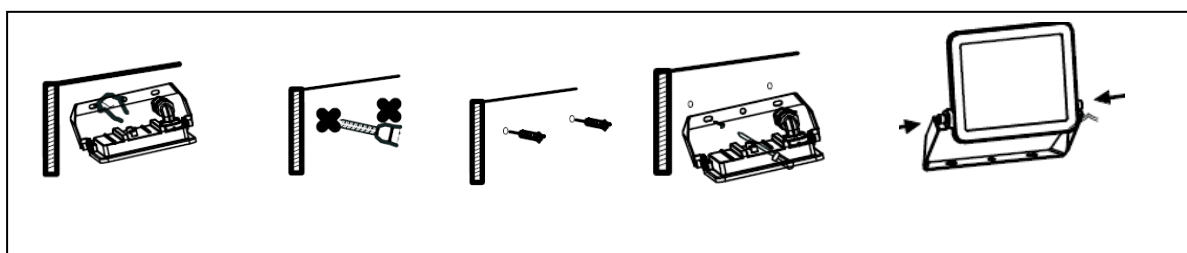

OPERATING THE FLOODLIGHT

Non PIR versions of the floodlight can be turned off and on using the wall switch or circuit breaker if using one.

For models which include the PIR function the floodlight is supplied with the PIR already activated and ready for use. The PIR settings can be changed using the switches located at the base of the PIR.



Time switch – Change the length of time the floodlight stays on when activated. The time range is from 7 seconds to a maximum of 7 minutes.

Lux switch – Decide the amount of light needed to activate the PIR and the light to switch on.

Sens – Determine the distance needed for the PIR to be triggered and the light to switch on.

To switch the PIR sensor off – using the mains switch, switch off and on again with 2 seconds.

To switch the PIR sensor on – using the mains switch, switch off and switch on again between 2 seconds and 10 seconds.

DISPOSAL



Only dispose of electrical appliances as designated municipal waste facilities. Contact your local government for information regarding the collection systems available. If electrical appliances are disposed of in landfills or dumps may prove hazardous to health.

GUARANTEE

The manufacturer provides the guarantee in accordance with the legislation of the customer's own country of residence, with a minimum of 1 year, starting from the date on which the appliance is sold to the end user.

The guarantee only covers defects in material or workmanship. The repairs under guarantee may only be carried out by an authorized service centre. When making a claim under guarantee, the original bill of purchase (with purchase date) must be submitted. The guarantee will apply only in cases of normal wear.

REGISTERED OFFICES

TCP UK Ltd, 1 Exchange Court, Cottingham Road, Corby, Northants NN17 1TY.

TCP France, Quai Gabriel P'ri, 1, Joinville Le Point, France. 94340.