

Laneri
sanitary ware

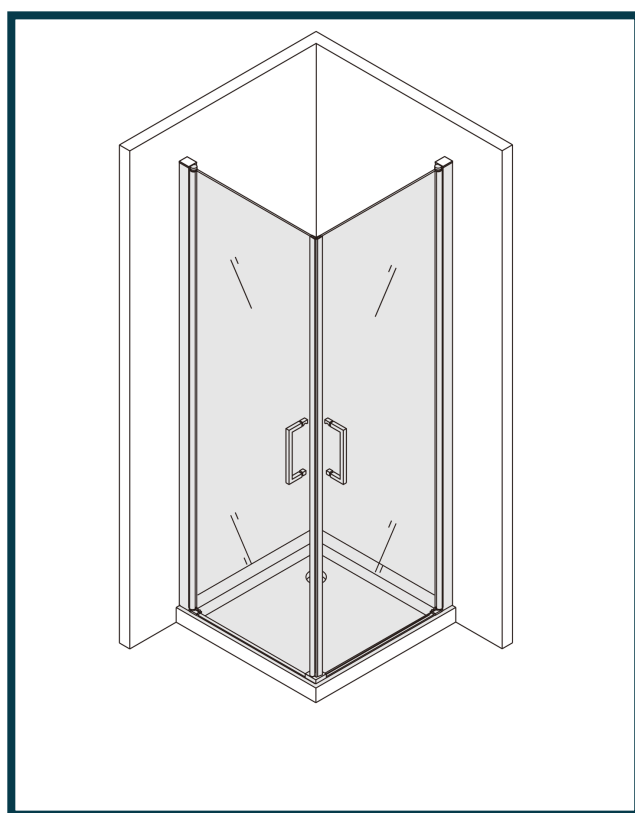

 YouTube LANERI SRL

Houston 2A



ITALIANO PAG. 3



FRANÇAIS PAG. 9



DEUTSCH PAG. 15

Laneri

sanitary ware

c/da Gentilomo snc
94100 Enna Italy
www.laneribagni.it

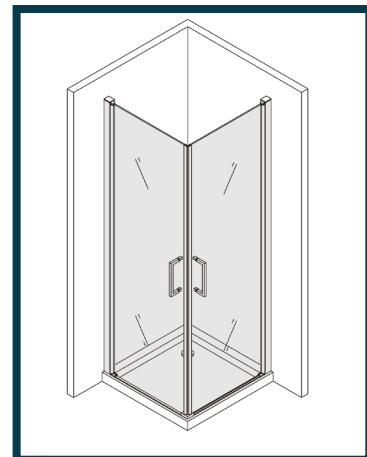

Houston 2A

DESCRIZIONE

Box doccia con doppia Porta battente ad angolo, vetro da 8 mm, lastra tutto vetro trasparente con trattamento easy-clean, profili in alluminio cromato. Altezza 200 cm , installazione reversibile.

ELABORATO TECNICO

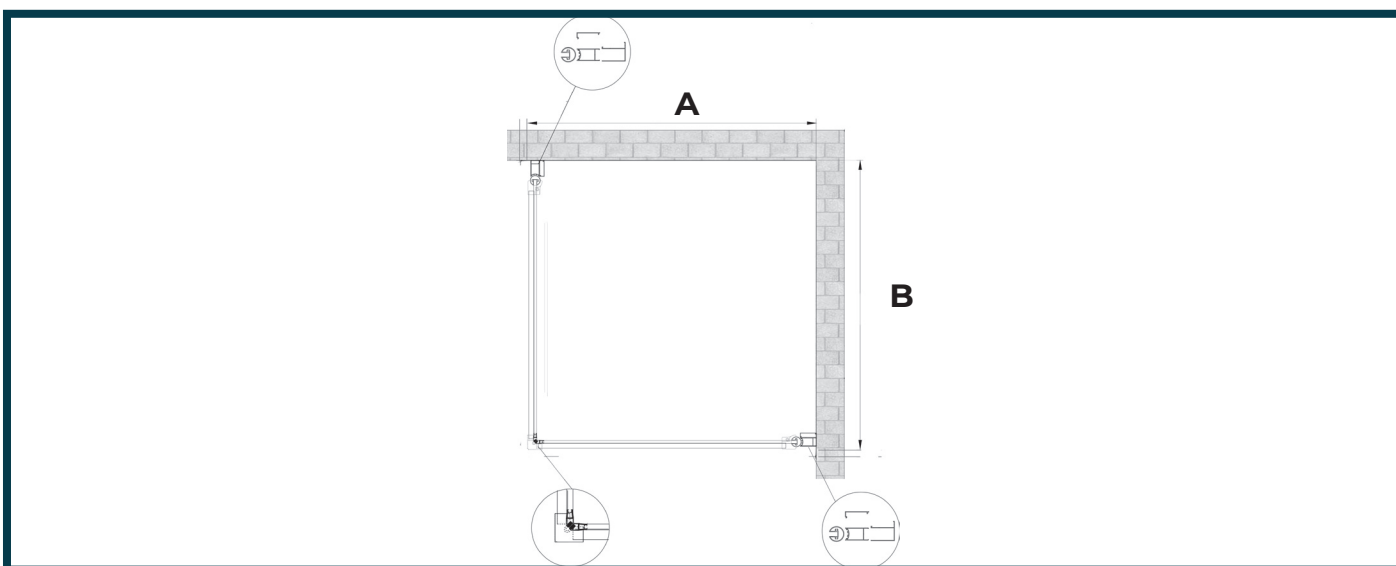

DETTAGLIO PROFILI

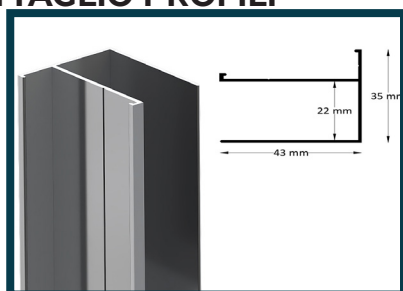

Profilo a muro

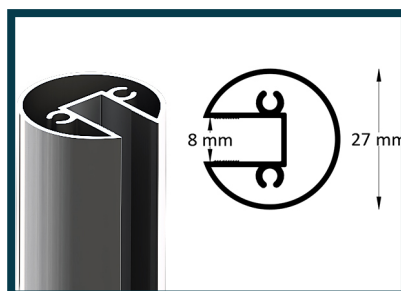

Cerniera

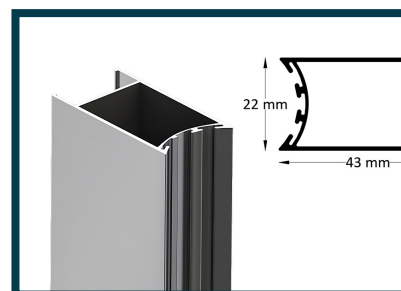

Profilo cerniera

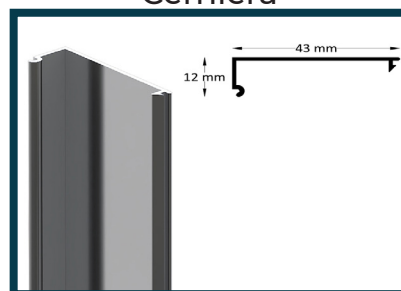

Cover

Laneri[®]

sanitary ware

c/da Gentilomo snc
94100 Enna Italy
www.laneribagni.it

Houston 2A



TABELLA MISURE

MODELLO	MISURE	
	A	B
65 x 65	615 - 635	615 - 635
70 x 70	665 - 685	665 - 685
70 x 80	665 - 685	765 - 785
70 x 90	665 - 685	865 - 885
75 x 75	715 - 735	715 - 735
80 x 80	765 - 785	765 - 785
85 x 85	815 - 835	815 - 835
90 x 90	865 - 885	865 - 885

HOUSTON 2A

UTENSILI NECESSARI

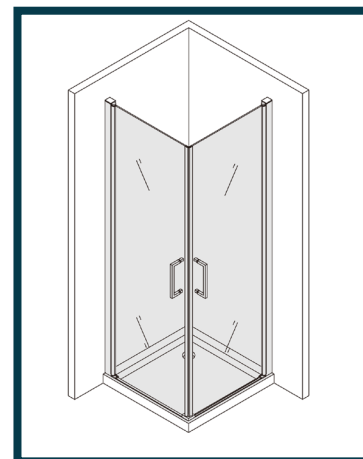
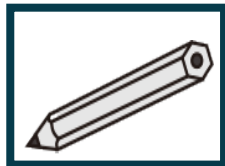

Matita

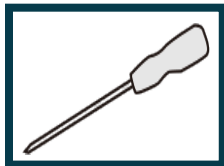

Cacciavite

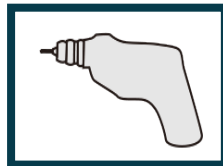

Trapano

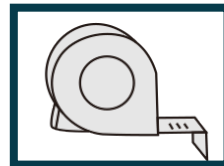

Metro a nastro

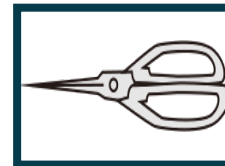

Forbice

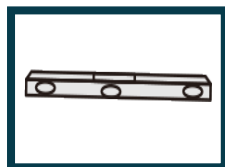

Livello



Chiave esagonale
(in dotazione)

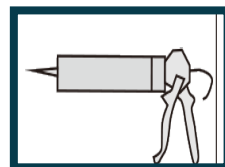

Silicone



Martello di
gomma

CONTENUTO DELLA CONFEZIONE

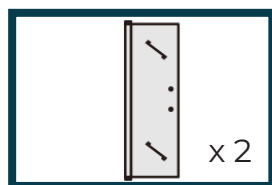

Vetro battente
8 mm

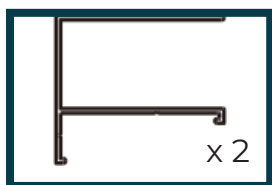

Profilo muro

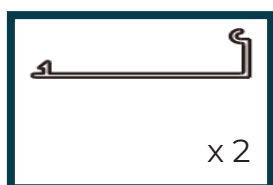

Cover profilo muro



Barra di tenuta
antigoccia



Guarnizione cala-
mita per vetro

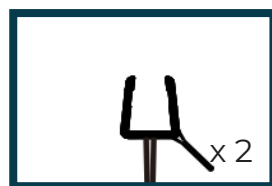

Guarnizione sotto-
vetro antigoccia

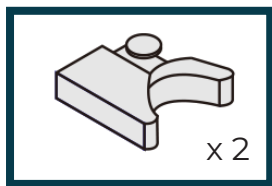

Supporti di fissag-
gio

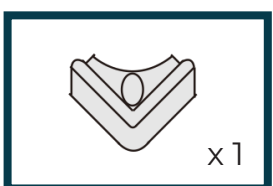

Supporti di fissag-
gio

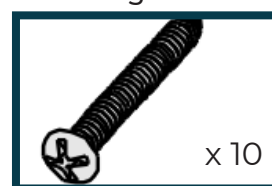

Vite 4 x 30

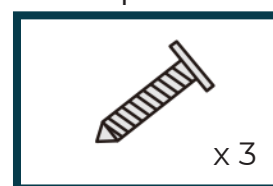

Vite 4 x 16

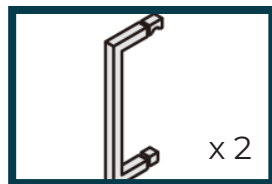

Maniglia

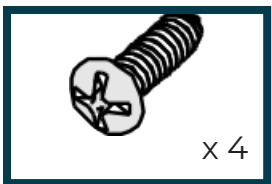

Vite 4 x 16

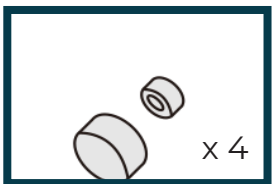

Guarnizione e co-
privite

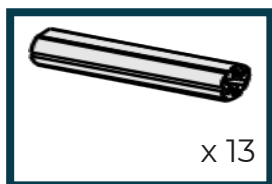

Tassello

MONTAGGIO

1° PASSAGGIO

1. Verificare la messa in bolla del piatto doccia con il livello.
2. Poggiare il profilo a muro ed utilizzare il livello per la messa a piombo.
3. Tracciare i fori a muro con la matita.
4. Praticare i fori a muro con il trapano.
5. Inserire il tassello a muro e avvitare le viti per fissare il profilo.

IMPORTANTE

è buona norma non montare i profili a ridosso del bordo esterno del piatto doccia, lasciare sempre circa 1,5 cm per un risultato estetico ottimale

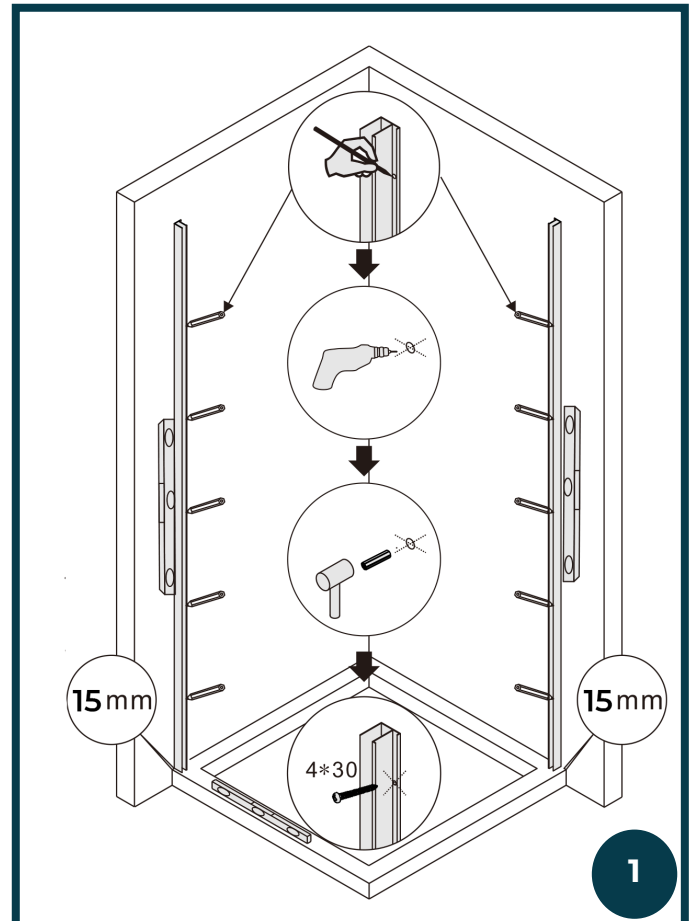

2° PASSAGGIO

1. Come mostrato in figura procedere con l'installazione delle due ante sui profili a muro, a destra e a sinistra.

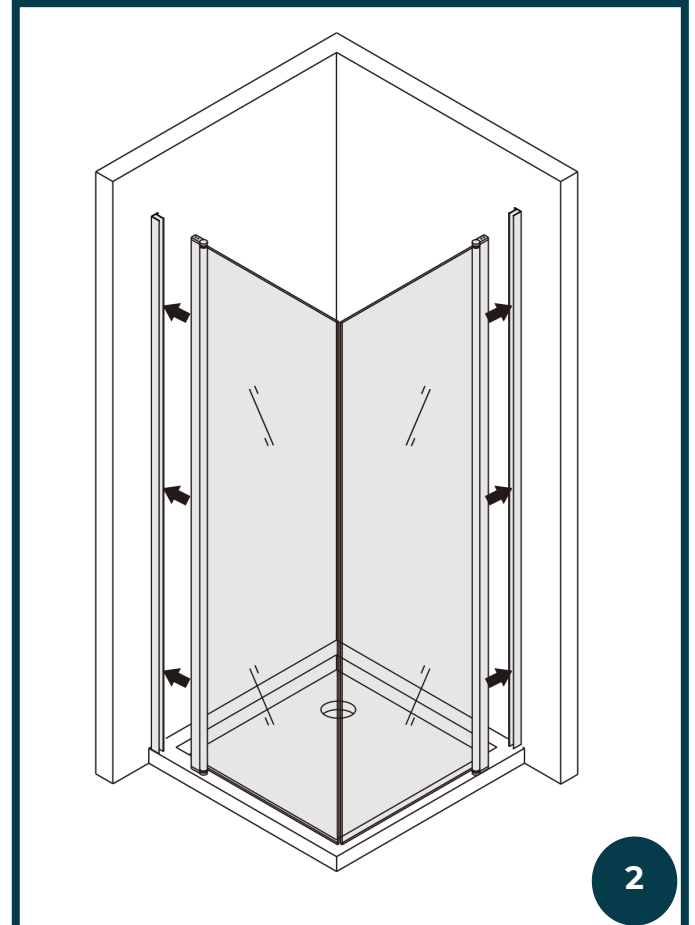

3° PASSAGGIO

1. Installare le guarnizioni magnetiche di chiusura sui vetri .
2. Praticare dei fori e applicare la vite dal lato interno per bloccare la parete doccia al profilo a muro tramite le viti 4x16 .

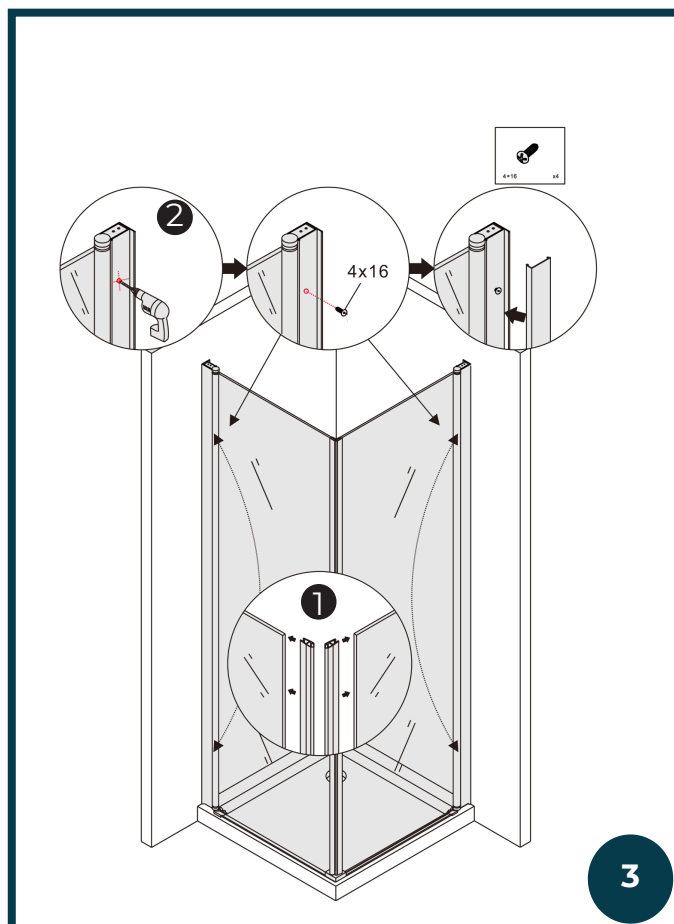

4° PASSAGGIO

1. Installare sul piatto il profilo di tenuta in alluminio fissandolo con del silicone.
2. Siliconare come mostrato in figura .

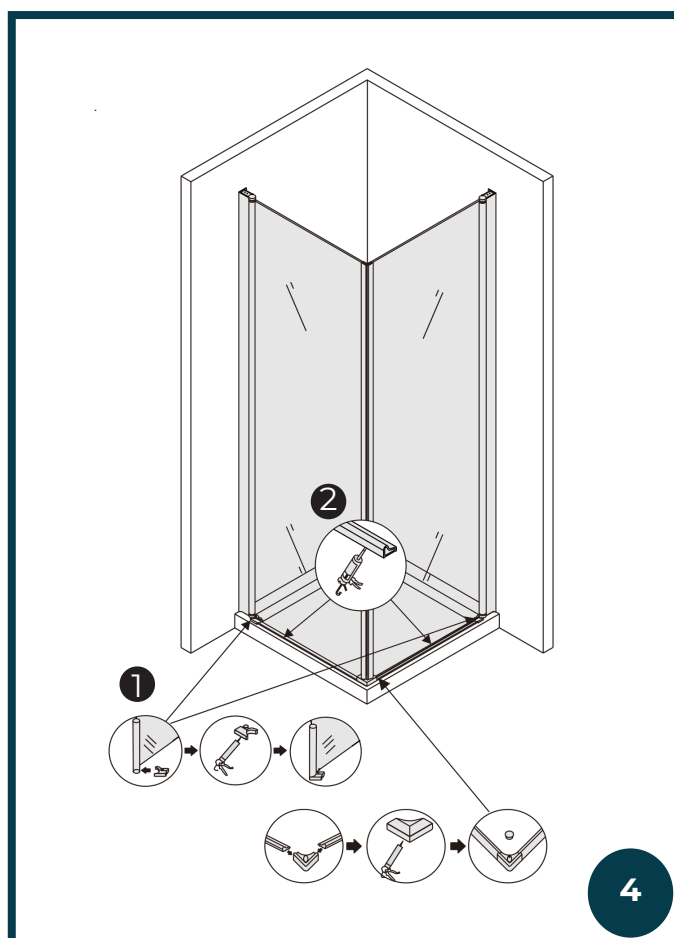

MONTAGGIO

5° PASSAGGIO

1. Installare la maniglia .
2. Installare la guarnizione di tenuta inferiore su vetri .
3. Applicare il silicone come mostrato in figura.

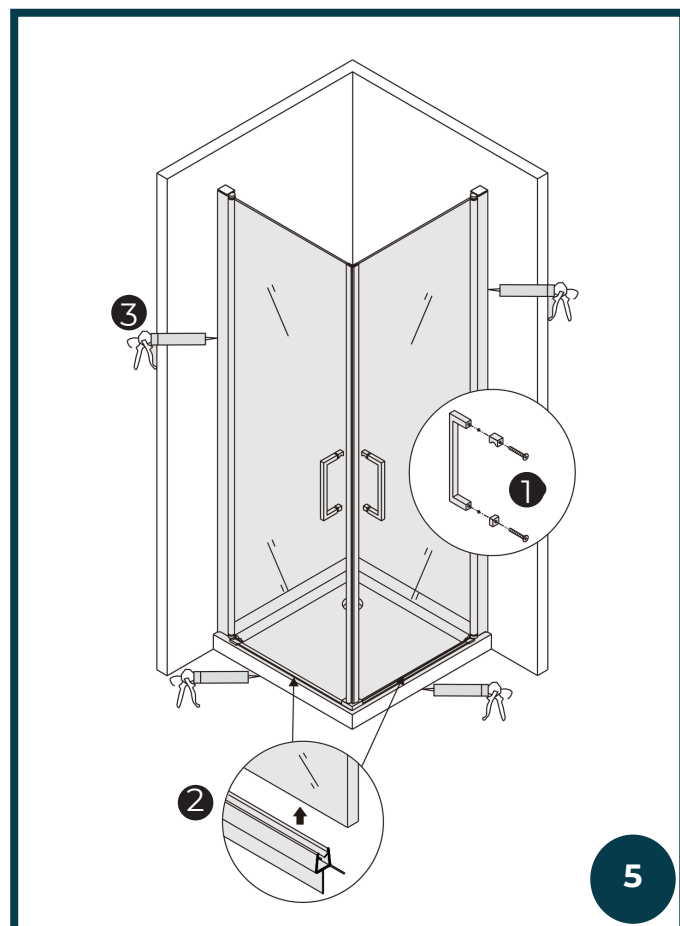

Laneri

sanitary ware

c/da Gentilomo snc
94100 Enna Italy
www.laneribagni.it

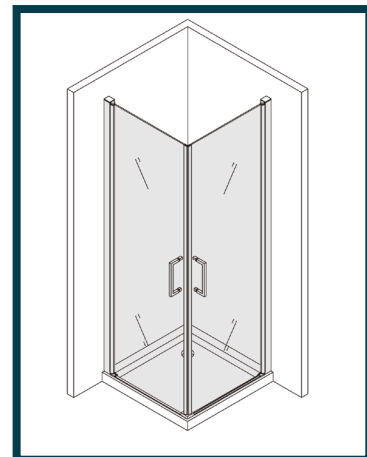

Houston 2A

DESCRIPTION

Porte de douche à battant angulaire. Verres de 8 mm transparents avec traitement anti-calcaire Easy-Clean. Profilées en aluminium chromé. Hauteur 200 cm. Installation réversible.

SPÉCIFICATION TECHNIQUE

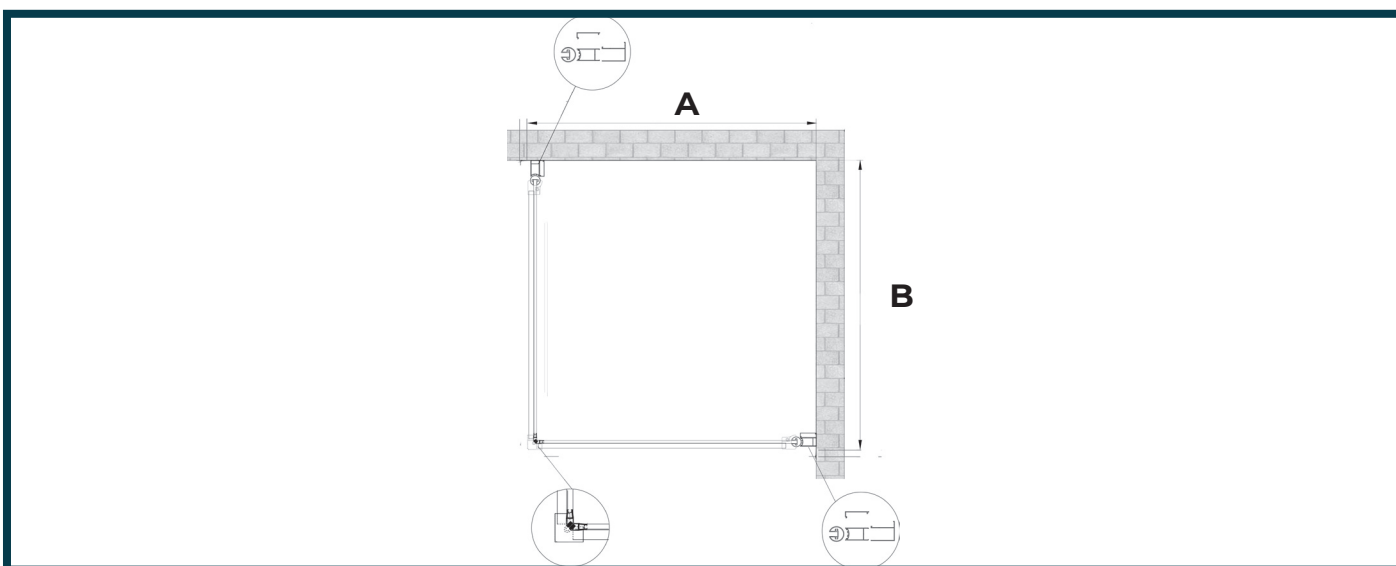

PROFILÉS EN DÉTAIL

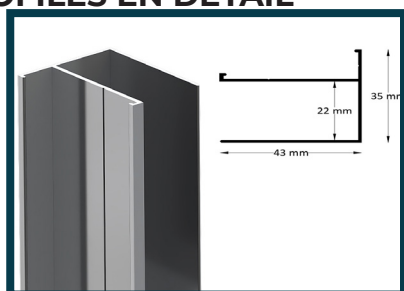

Profilé mural fixe

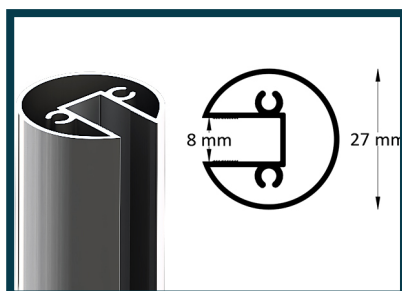

Charnière

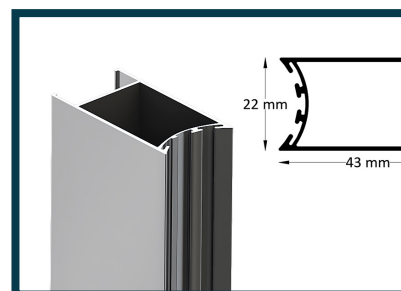

Profilé charnière

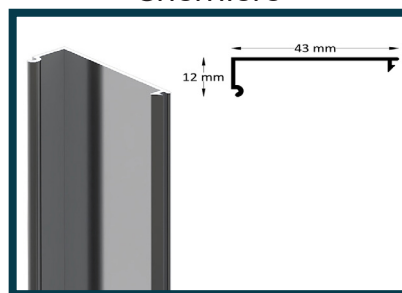

Profilé de couverture

Laneri[®]

sanitary ware

c/da Gentilomo snc
94100 Enna Italy
www.laneribagni.it

Houston 2A

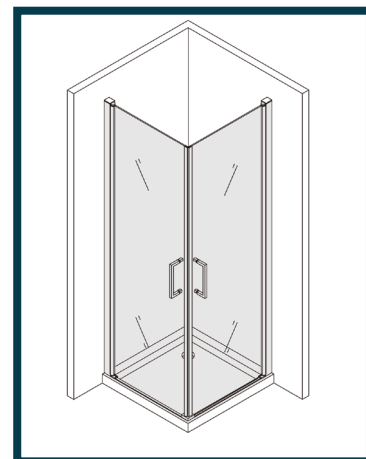

FICHE DES TAILLES

MODÈLE	MERSURES	
	A	B
65 x 65	615 - 635	615 - 635
70 x 70	665 - 685	665 - 685
70 x 80	665 - 685	765 - 785
70 x 90	665 - 685	865 - 885
75 x 75	715 - 735	715 - 735
80 x 80	765 - 785	765 - 785
85 x 85	815 - 835	815 - 835
90 x 90	865 - 885	865 - 885

HOUSTON 2A

USTENSILES NECESSAIRES



Crayon



Tournevis

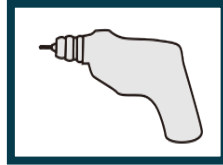

Forage

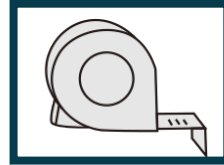

Ruban à mesurer

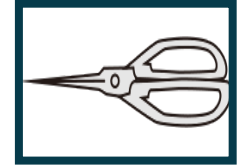

Ciseaux

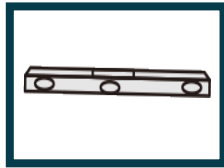

Niveau



Clé à douille
(en dotation)

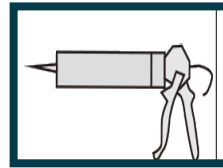

Silicone

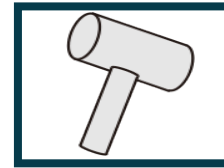

Maillet en ca-
outchouc

ACCESSOIRES INCLUS DANS LE COLIS

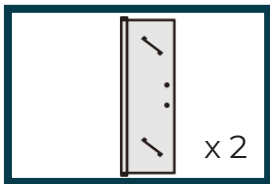

Verre trempé à battant 8 mm

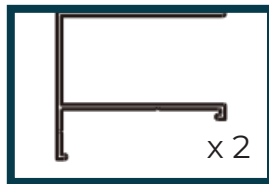

Profilé mural

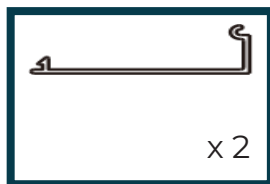

Profilé de couverture



Barre d'étanchéité
anti-goutte

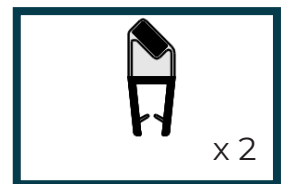

Joint magnétique

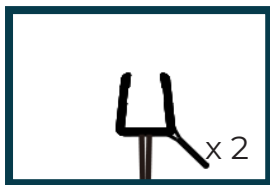

Joint sous-verre
anti-gouttes

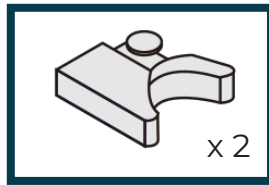

Support de fixation
au sol



Support de fixation
au sol



Vis 4 x 30

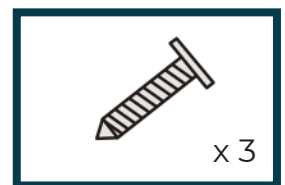

Vis 4 x 16

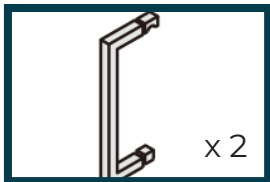

Poignée

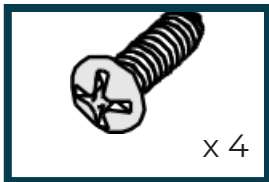

Vis 4 x 16

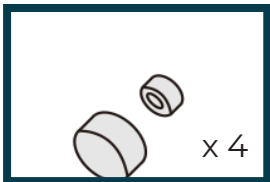

Capouchons cou-
vre-vis avec supports

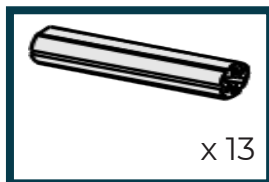

Morceaux

Installation

1° ÉTAPE

1. Vérifiez le nivellement du receveur de douche avec le niveau
2. Appuyez le profilé mural et utiliser le niveau pour la mise à plombe.
3. Tracez les trous sur le mur avec le crayon.
4. Faites les trous avec le forage.
5. Placez les morceaux et vissez les vis pour fixer le profilé à la paroi.

IMPORTANTE

Nous recommandons de pas installer le profilé à proximité du bord extérieur du receveur de douche, mais de laisser au moins 1,5 cm du bord, pour une installation optimale.

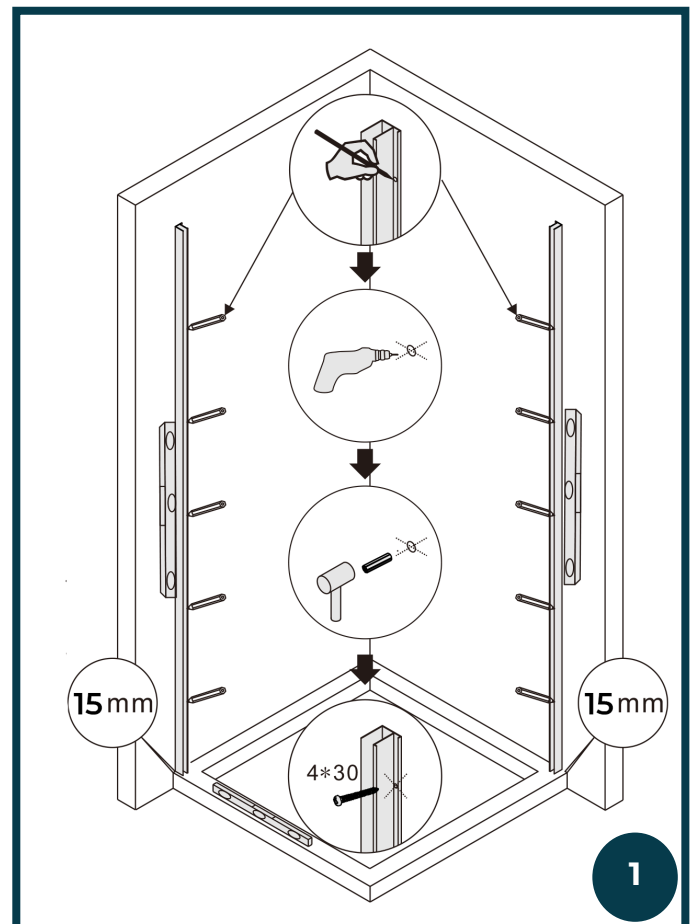

2° ÉTAPE

1. Selon l'illustration, procédez avec l'installation des deux portes sur les profilé mural, à droite et à gauche.

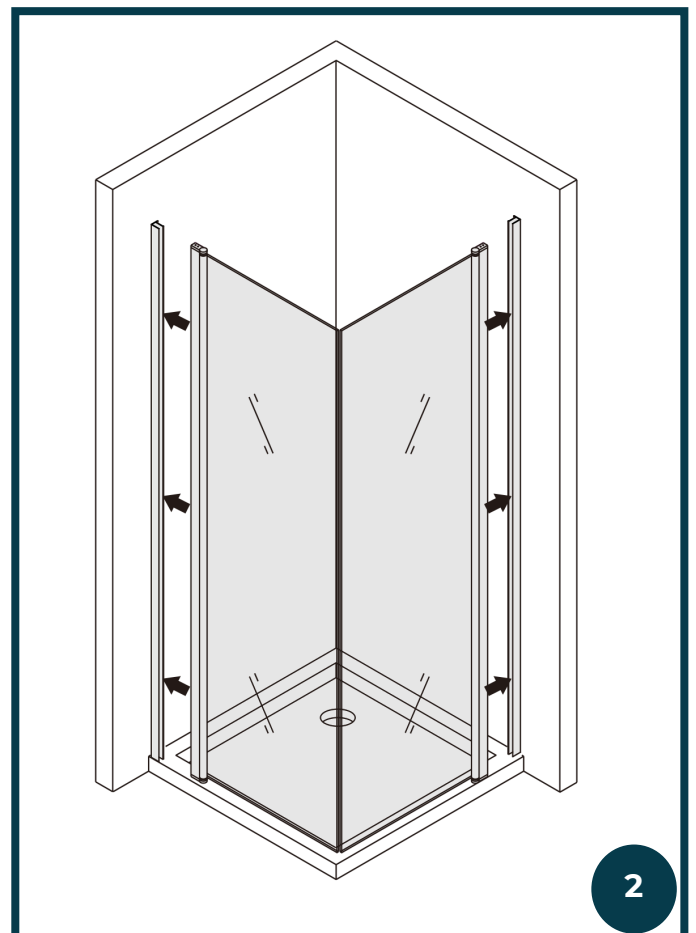

3° ÉTAPE

1. Installez les joints magnétiques de fermeture sur les verres.
2. Faites les trous et appliquez la vis sur la face intérieure pour bloquer la paroi de la douche au profilé mural à travers de les vis 4x16.

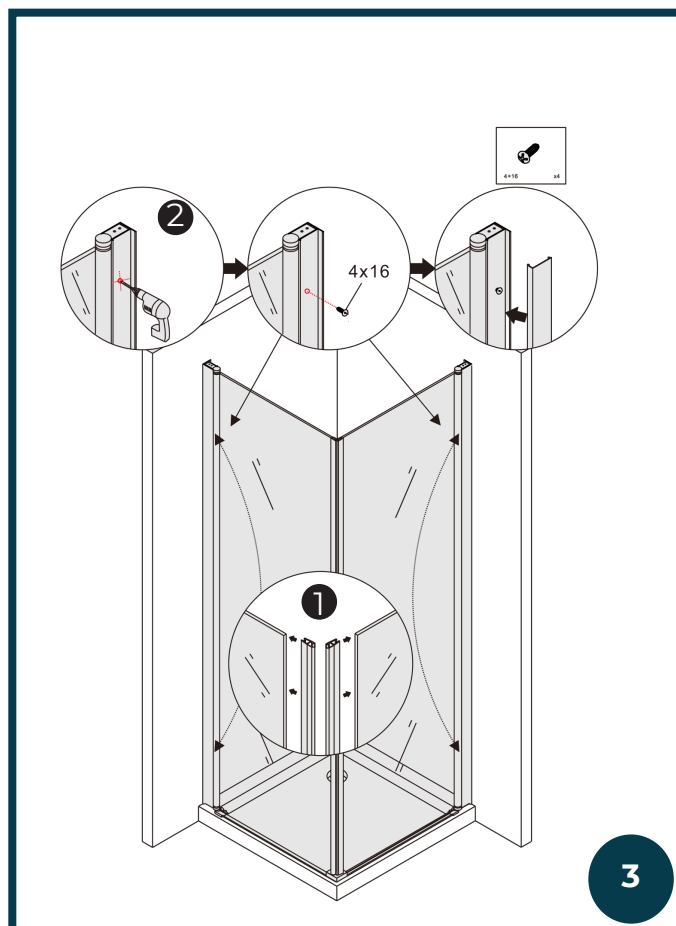

4° ÉTAPE

1. Installez sur le receveur de douche le profilé d'étanchéité en aluminium en fixant avec le silicone.
2. Mettez le silicone selon l'illustration.

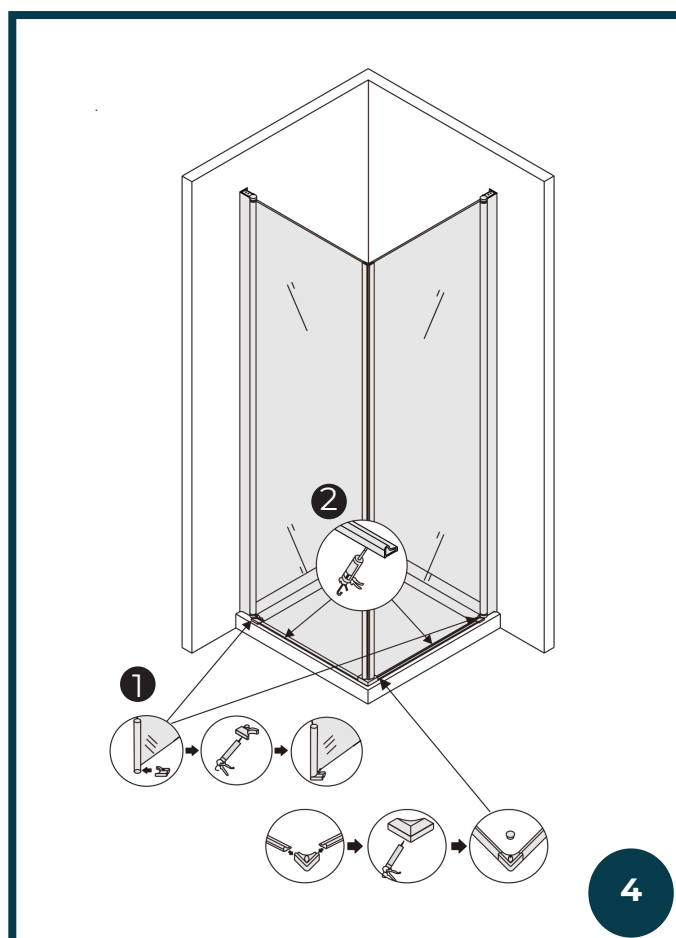

5° ÉTAPE

1. Installez le poignées.
2. Installez le joint d'étanchéité inférieur sur les verres.
3. Mettez le silicone selon l'illustration .

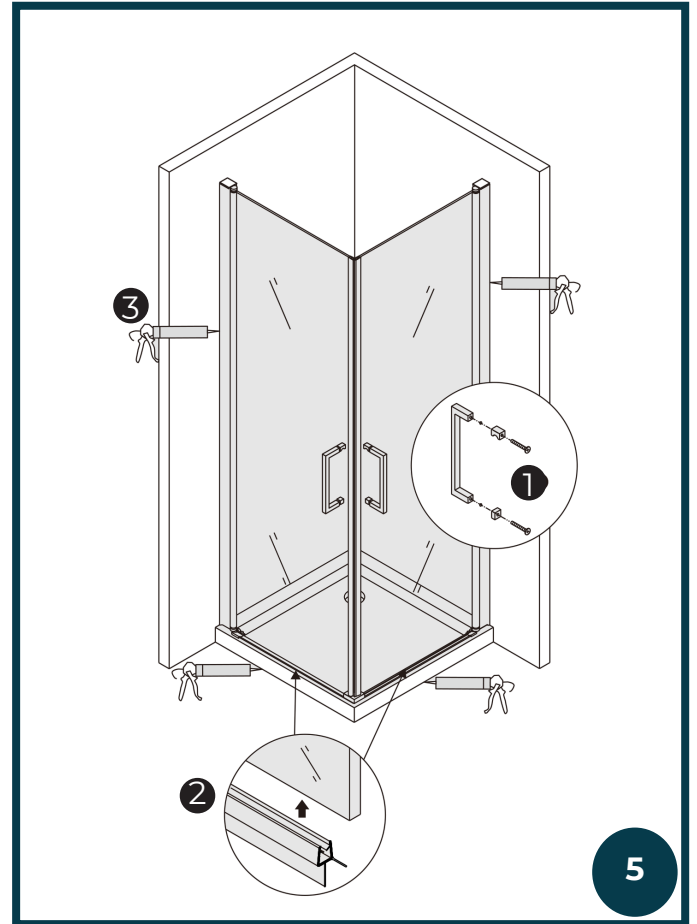

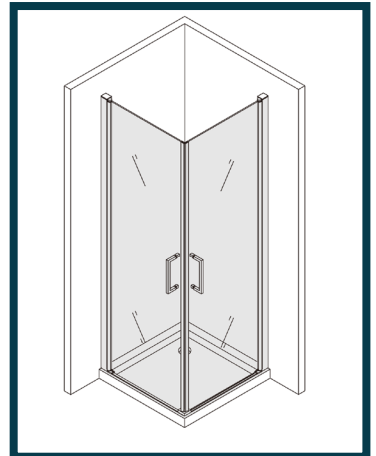

Houston 2A

BESCHREIBUNG

Duschabtrennung mit Doppel-Eckflügeltür, 8 mm Glas, vollständig transparente Glasscheibe mit Easy-Clean-Beschichtung, verchromte Aluminiumprofile. Höhe 200 cm, beidseitige Installation.

TECHNISCHE BESCHREIBUNG

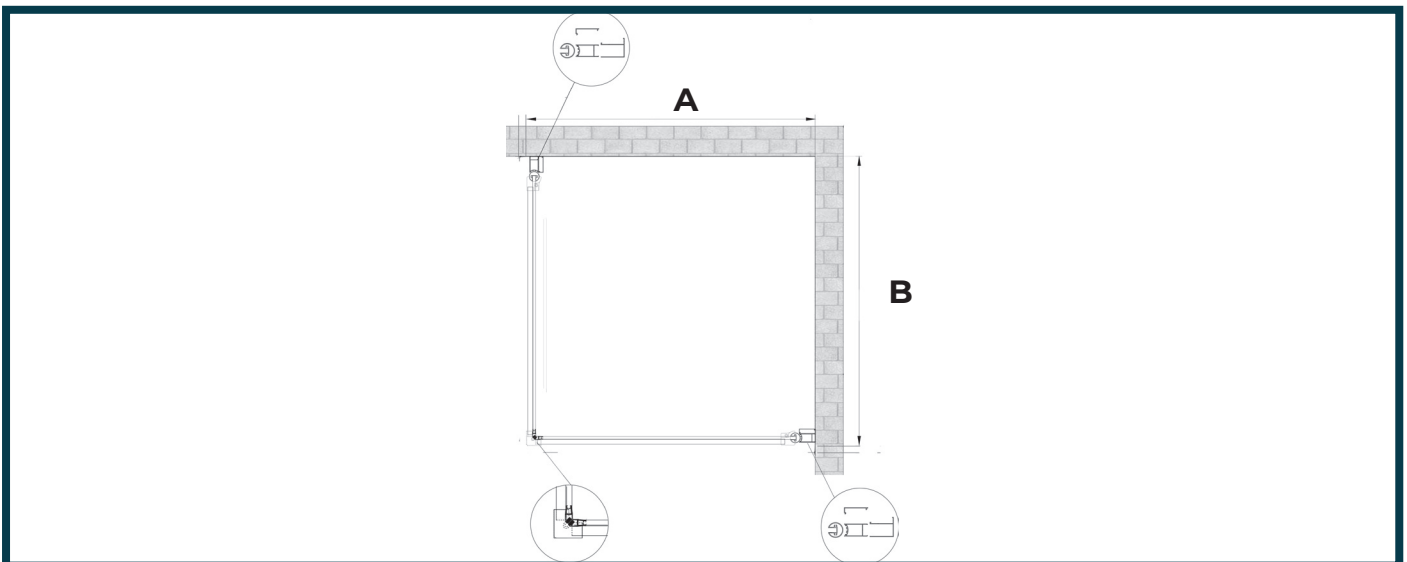

DETAILS ZUBEHÖR

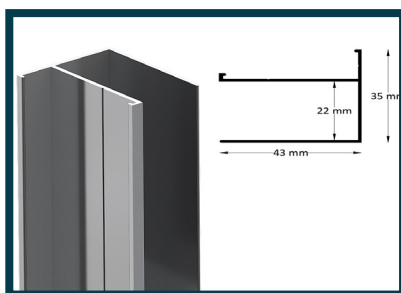

Festes Wandelement

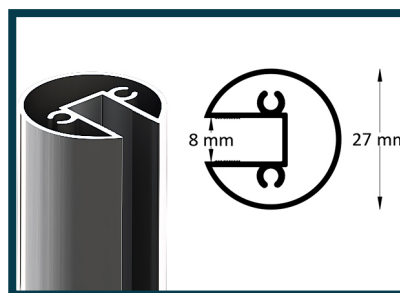

Scharnier

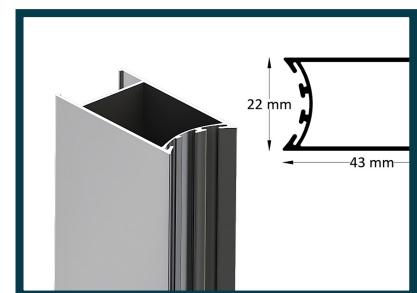

Scharnier

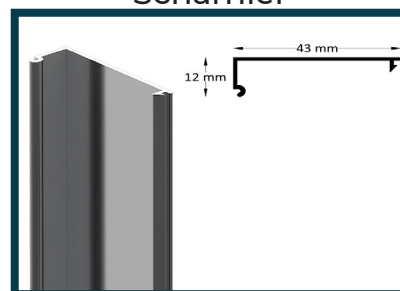

Abdeckelement

Laneri®

sanitary ware

c/da Gentilomo snc
94100 Enna Italy
www.laneribagni.it

Houston 2A

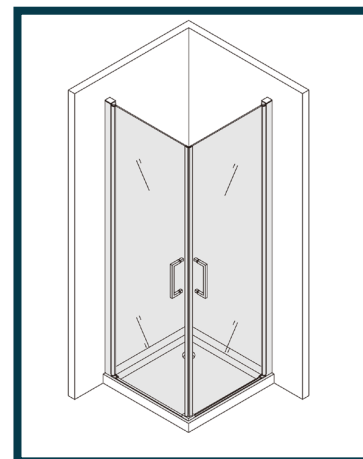

GRÖSSENTABELLE

MODELL	ABMESSUNGEN	
	A	B
65 x 65	615 - 635	615 - 635
70 x 70	665 - 685	665 - 685
70 x 80	665 - 685	765 - 785
70 x 90	665 - 685	865 - 885
75 x 75	715 - 735	715 - 735
80 x 80	765 - 785	765 - 785
85 x 85	815 - 835	815 - 835
90 x 90	865 - 885	865 - 885

HOUSTON 2A

BENÖTIGTE WERKZEUGE

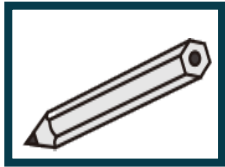

Bleistift

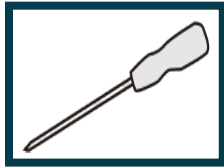

Schraubendreher

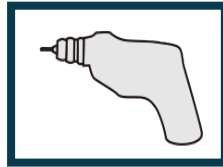

Bohrer

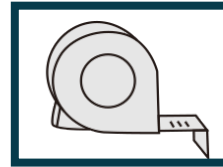

Maßband

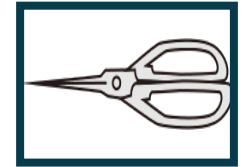

Schere

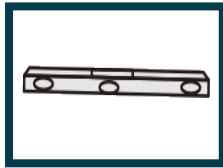

Wasserwaage



Sechskantschlüssel
(mitgeliefert)

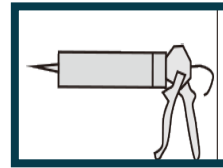

Silikon



Gummihammer

PAKETINHALT

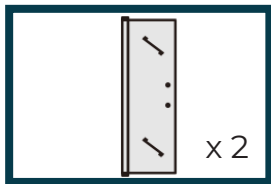

Schwingtür aus
gehärtetem Glas

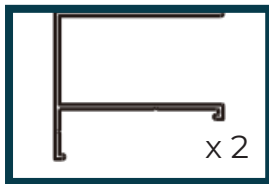

Wandelement

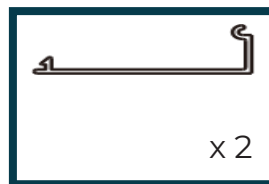

Wandelementab-
deckung



Dushdichtungslei-
ste

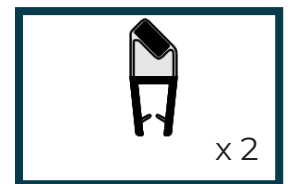

Magnetdichtung

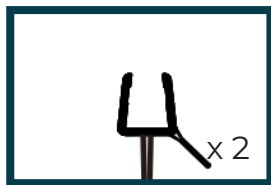

Spritzschutzdichtun-
gen unter der Glastür

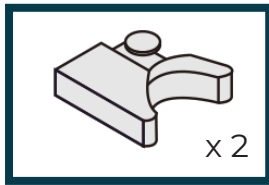

Bodenbefestigun-
gsstützen



Bodenbefestigun-
gsstützen



Schrauben 4 x 30

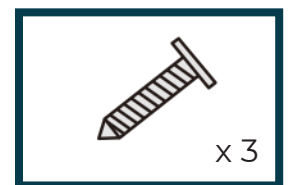

Schrauben 4 x 16

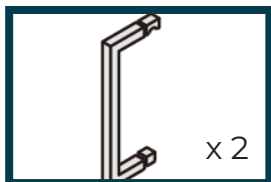

Griff

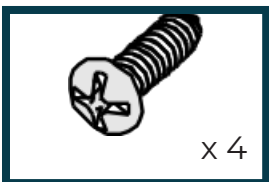

Schrauben 4 x 16

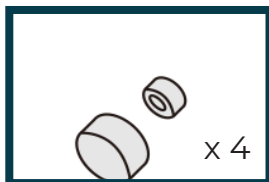

Schraubverschlüsse
mit Stützen

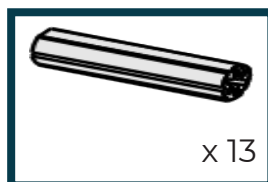

Dübel

MONTAGE

1. SCHRITT

1. Achten Sie darauf, dass die Duschwanne gerade ist.
2. Platzieren Sie das Profil an der Wand und verwenden Sie die Wasserwaage für die Ausrichtung.
3. Markieren Sie die Löcher in der Wand mit dem Bleistift.
4. Bohren Sie mit dem Bohrer die Löcher in die Wand.
5. Setzen Sie den Dübel ein und schrauben Sie die Schrauben fest, um das Element zu befestigen.

WICHTIG

Es wird empfohlen, die Elemente nicht direkt an der Außenkante der Duschwanne anzubringen, lassen Sie immer etwa 1,5 cm Abstand für ein optimales ästhetisches Ergebnis

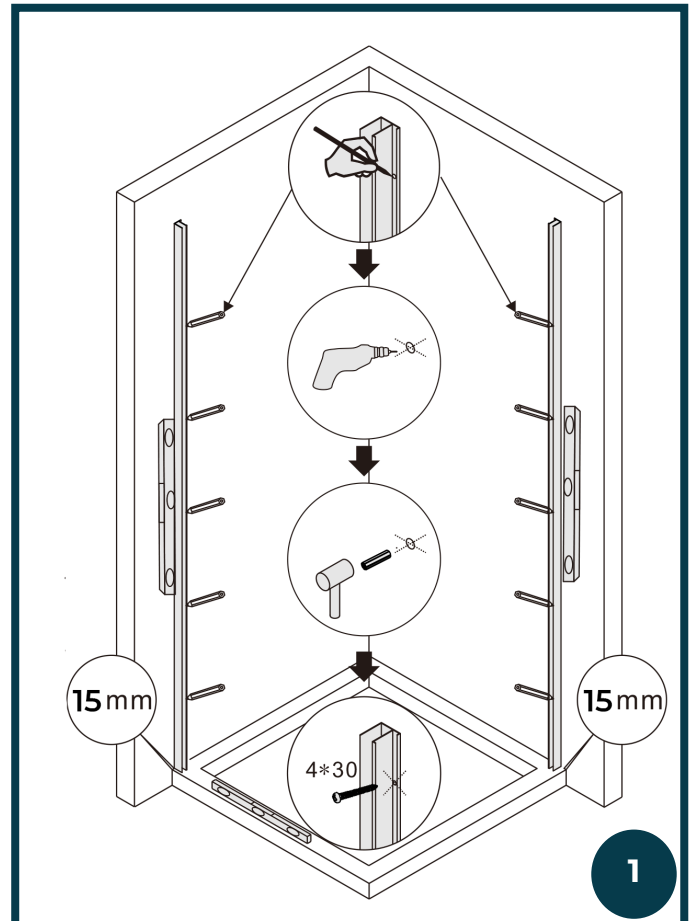

2. SCHRITT

1. Fahren Sie wie in der Abbildung gezeigt mit der Montage der beiden Türen an den Wandprofilen rechts und links fort.

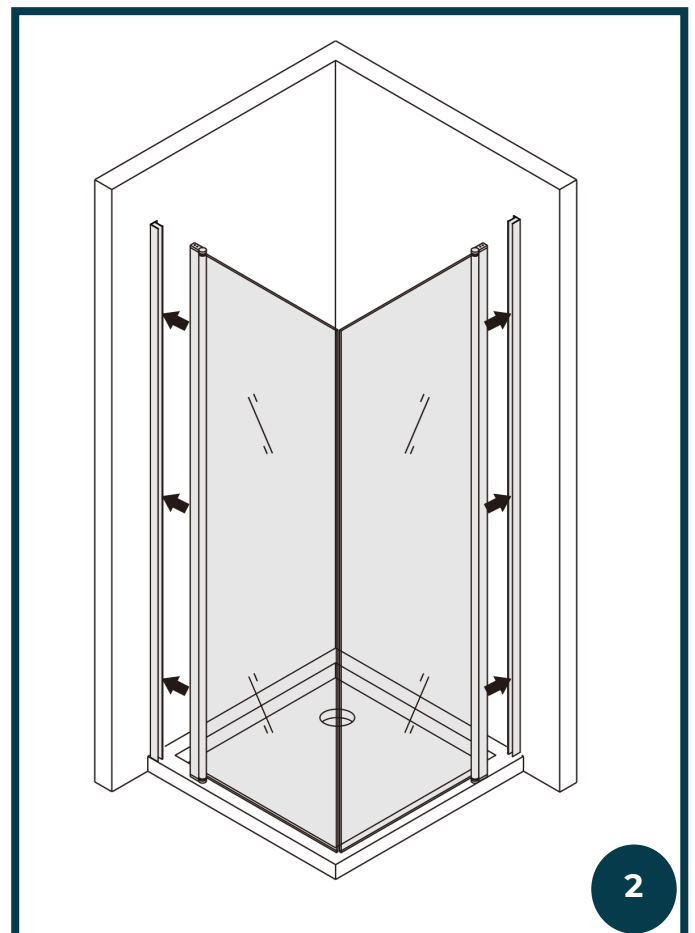

3. SCHRITT

1. Bringen Sie die magnetischen Verschlussdichtungen am Glas an.
2. Bohren Sie Löcher und befestigen Sie die Schraube von innen, um die Duschwand mit den 4x16-Schrauben am Wandprofil zu befestigen.

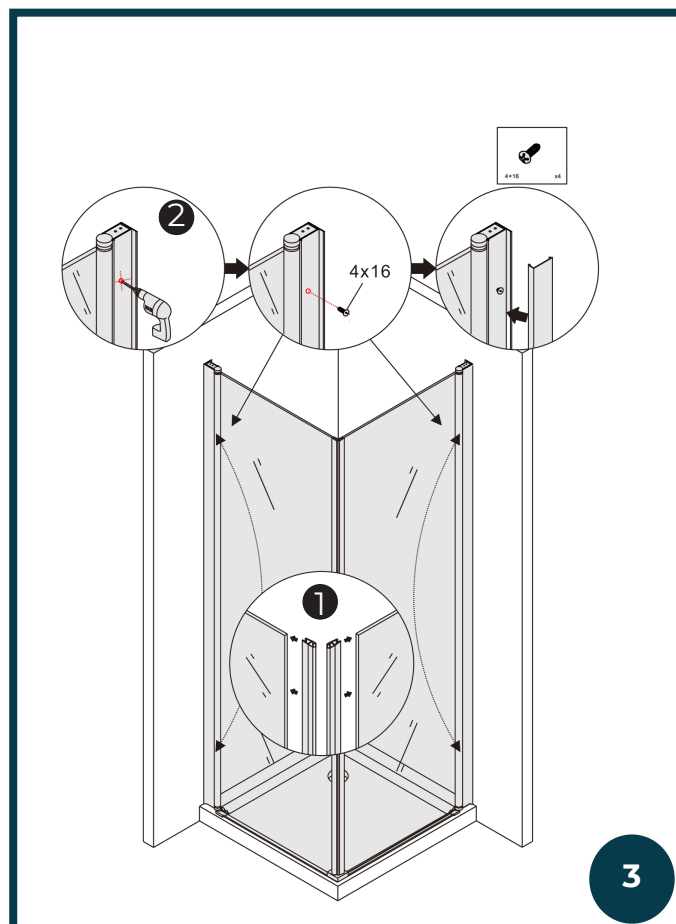

4. SCHRITT

1. Installieren Sie das Aluminium-Dichtprofil auf der Platte und fixieren Sie es mit Silikon.
2. Tragen Sie das Silikon wie in der Abbildung gezeigt auf.

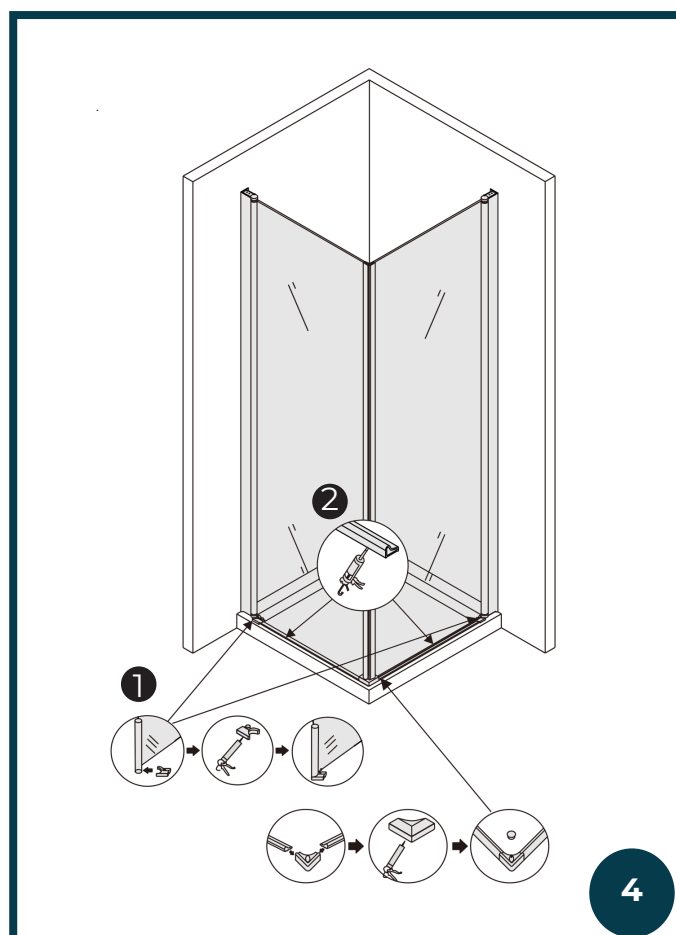

MONTAGGIO

5. SCHRITT

1. Montieren Sie den Griff.
2. Bringen Sie die untere Dichtung am Glas an.
3. Tragen Sie das Silikon wie in der Abbildung gezeigt auf.

