

# Simple

---

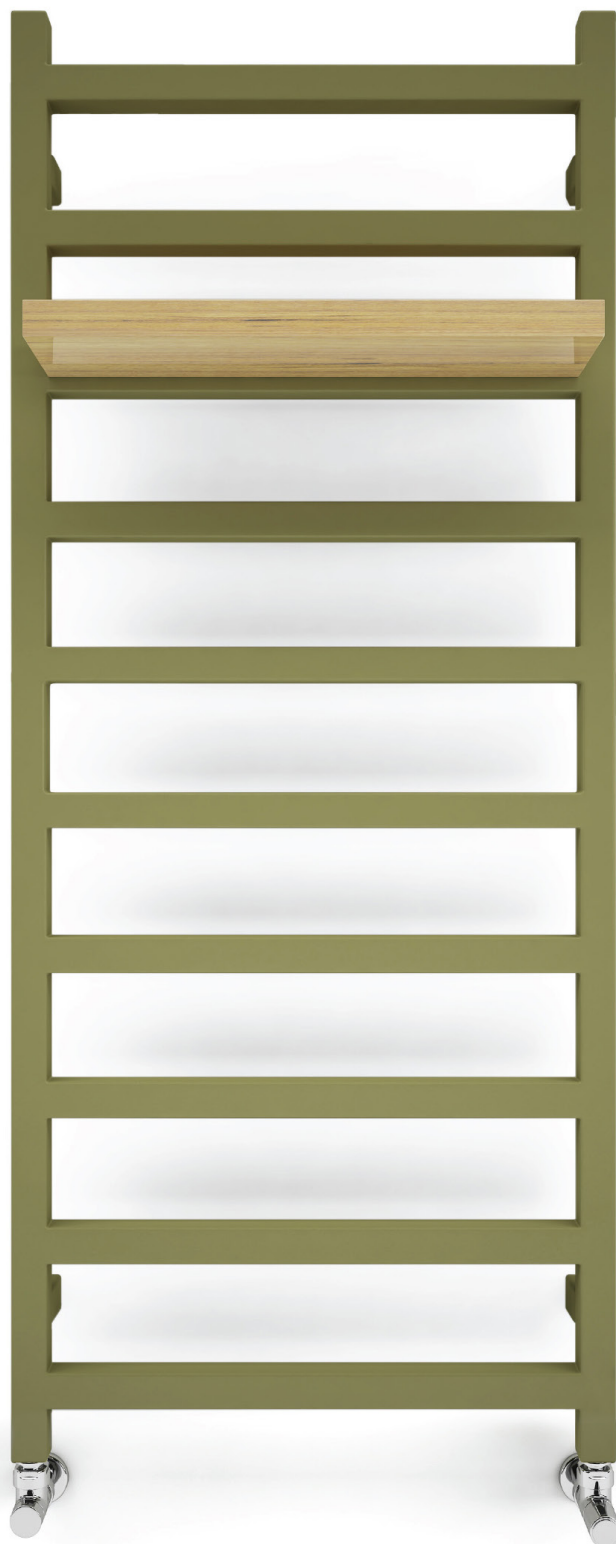

RAL 6023

# Simple

## Raccordements

Chauffage central



Électrique



Mixte



## Dimensions disponibles

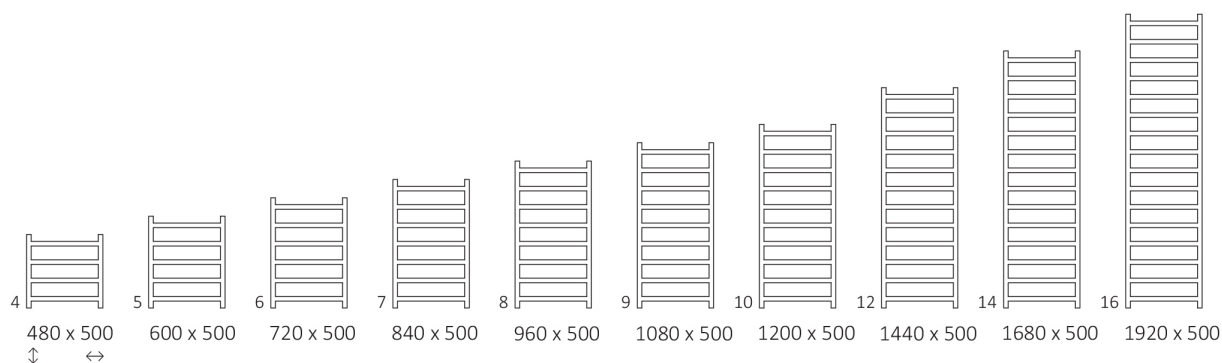





# Simple

## Données techniques

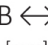
Pression du travail : 1000 kPa

Température maximale de travail : 95°C

A  [mm]	B  [mm]	C1 [mm]	C2 [mm]	75/65/20°C [W]	55/45/20°C [W]	 [W]	D [mm]	E [mm]	F [mm]	 [dm³]	 [kg]
<b>Peinture epoxy</b>											
480	500	50	470	173	100	200	470	240	120	1,28	3,84
600	500	50	470	217	123	200	470	360	120	2,16	4,74
720	500	50	470	262	145	300	470	480	120	2,92	5,64
840	500	50	470	306	167	300	470	600	120	3,24	6,54
960	500	50	470	351	189	400	470	720	120	3,56	7,43
1080	500	50	470	396	211	400	470	840	120	4,88	8,06
1200	500	50	470	440	234	400	470	960	120	4,32	9,23
1440	500	50	470	529	271	500	470	1200	120	5,84	11,03
1680	500	50	470	618	308	600	470	1440	120	6,48	12,83
1920	500	50	470	707	343	800	470	1680	120	7,12	14,63
<b>Revêtement galvanique</b>											
480	500	50	470	121	70	100	470	240	120	1,28	3,72
600	500	50	470	152	86	100	470	360	120	2,16	4,58
720	500	50	470	183	102	200	470	480	120	2,92	5,45
840	500	50	470	214	117	200	470	600	120	3,24	6,32
960	500	50	470	246	132	300	470	720	120	3,56	7,19
1080	500	50	470	277	148	300	470	840	120	4,88	8,06
1200	500	50	470	308	164	300	470	960	120	4,32	8,93
1440	500	50	470	370	190	400	470	1200	120	5,84	10,67
1680	500	50	470	433	216	400	470	1440	120	6,48	12,40

# Simple

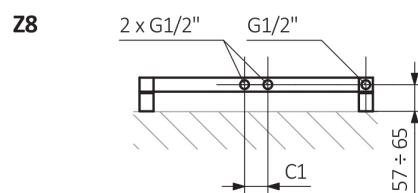
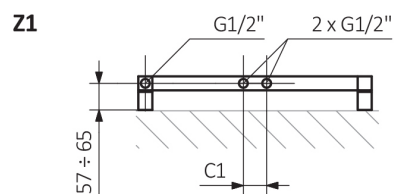
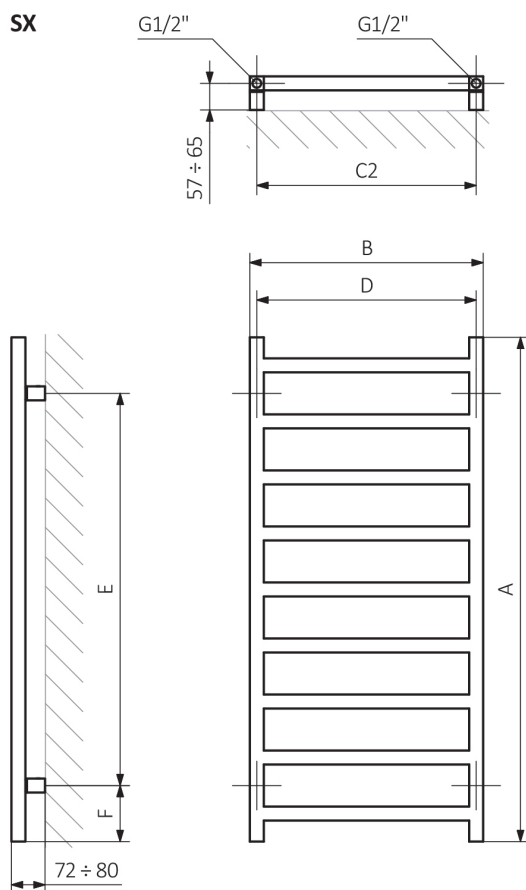

A – hauteur B – largeur C1-C5 – écartement des raccords D – écartement des consoles en horizontal E – écartement des consoles en vertical F – distance de l'axe de la console inférieure au bord inférieur du collecteur

**Tube :**

