

MONTAGEANLEITUNG

(Assembly Instructions)

SKU:HFSN-1228

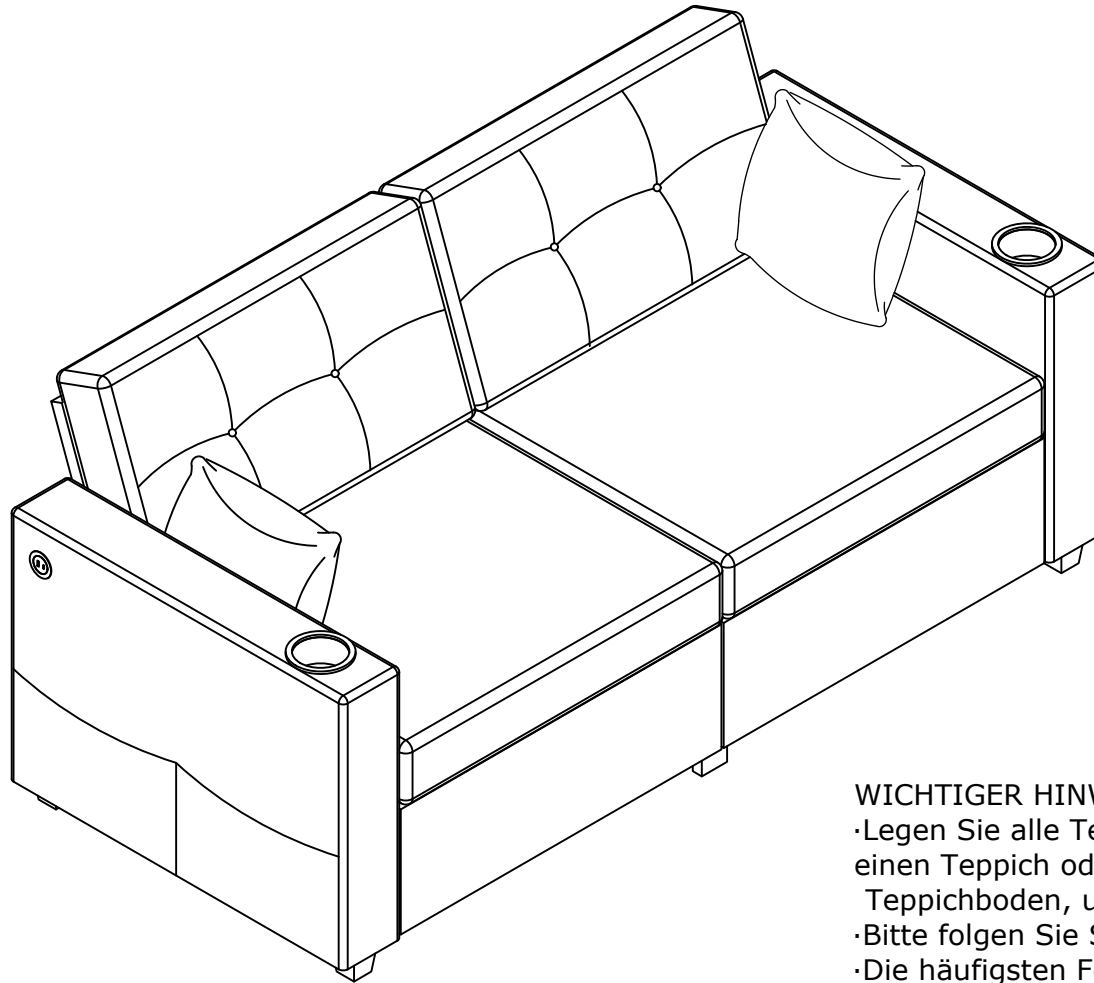

WICHTIGER HINWEIS:

- Legen Sie alle Teile auf eine saubere und glatte Oberfläche, wie z. B. einen Teppich oder Teppichboden, um zu verhindern, dass die Teile zerkratzt werden.
- Bitte folgen Sie Schritt für Schritt der Montageanleitung.
- Die häufigsten Fehler bei der Montage sind die Verwendung falscher Befestigungselemente oder das Vertauschen von Komponenten von vorne nach hinten.
- Ziehen Sie alle Schrauben erst dann vollständig an, wenn der Schritt oder Prozess abgeschlossen ist.

MONTAGEANLEITUNG (Assembly Instructions)

BOX A



M8*16
A.x8



M8*45
B.x4



M8*50
C.x4

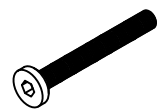

M8*65
D.x1



M6*15
E.x4



M8
F.x1



M8
G.x1



M8
H.x1



M8*25
I.x2



M6*16
J.x10



M6
K.x1



5.x2



6.x2



8.x4



9.x8



10.x4

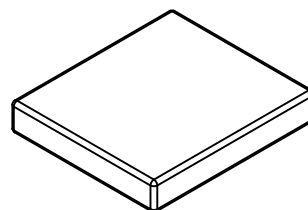

13.x2

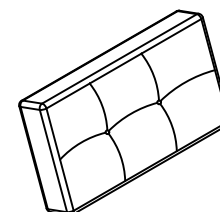

14.x2

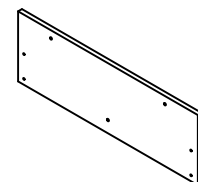

17.x2

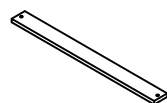

18.x1

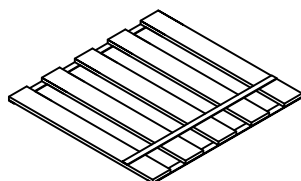

19.x2



20.x4



21.x4



22.x1

MONTAGEANLEITUNG (Assembly Instructions)

BOX B

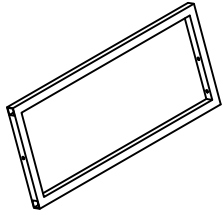

1. x2



2. x2

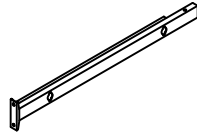

3. x2

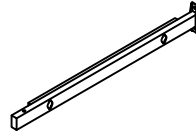

4. x2

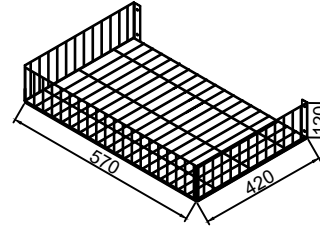

7. x2

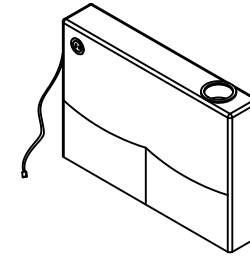

11. x1

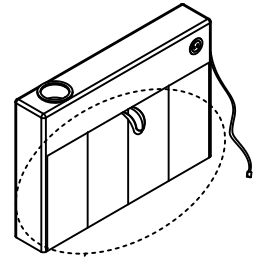

12. x1

Öffnen Sie das Paket/Gerät und nehmen Sie ein Bauteil Nr. 15 und zwei Bauteile Nr. 16 heraus.

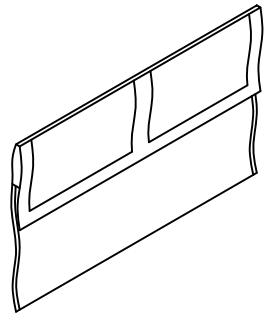

15. x1

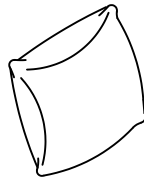

16. x2

MONTAGEANLEITUNG (Assembly Instructions)

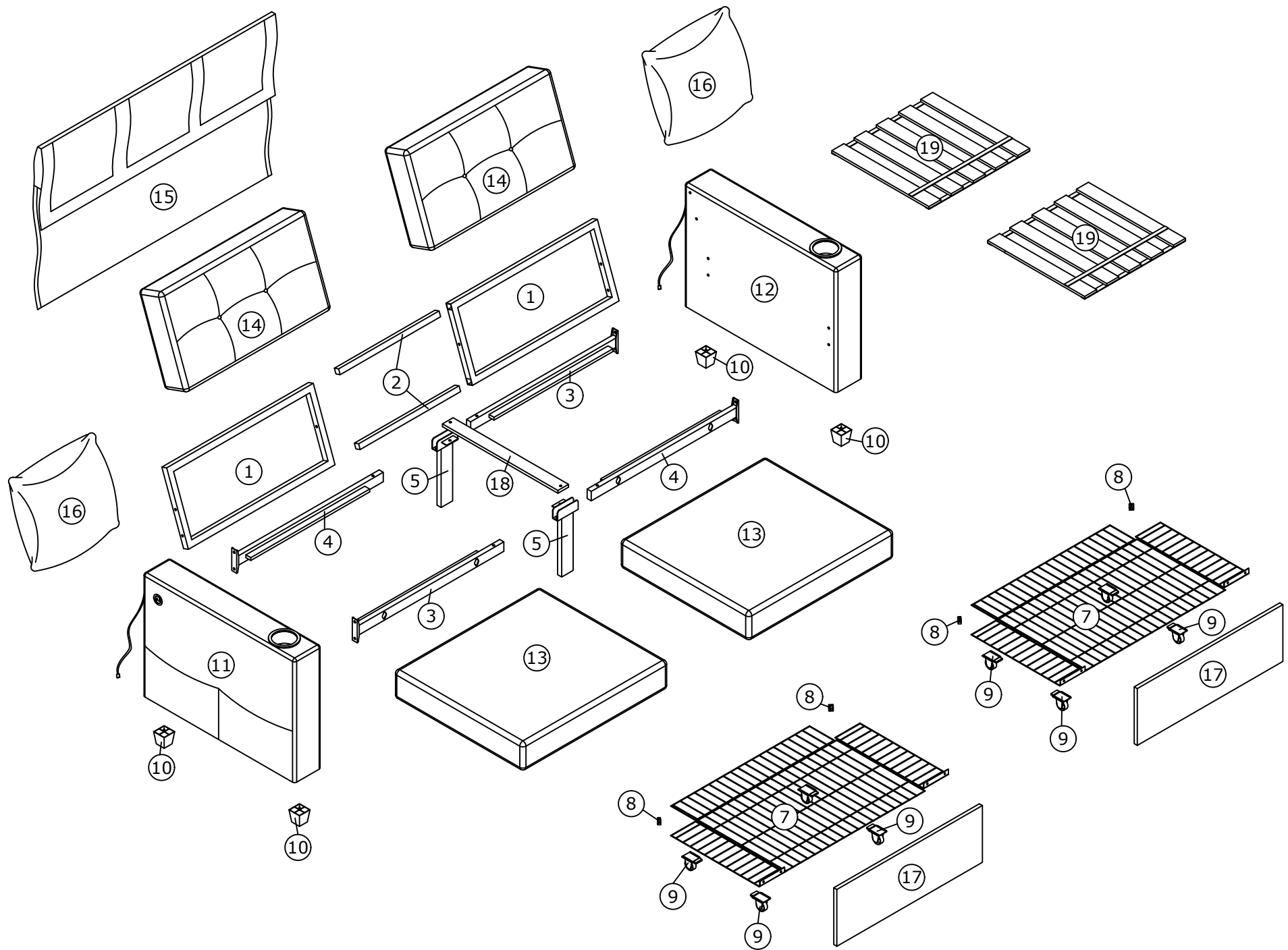

MONTAGEANLEITUNG (Assembly Instructions)

Step:1

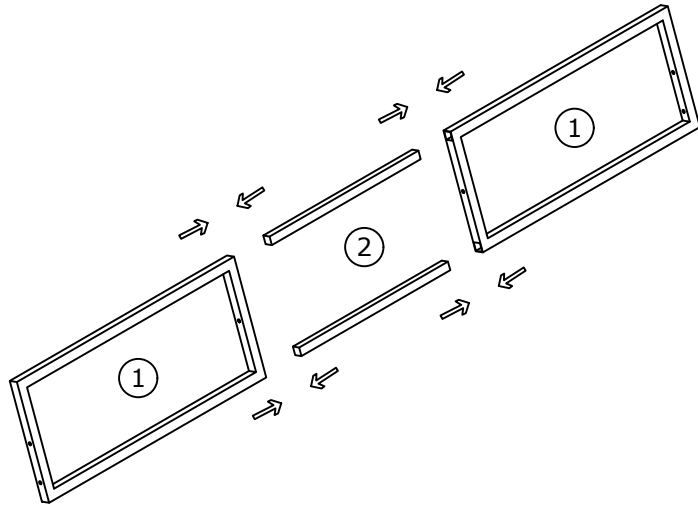

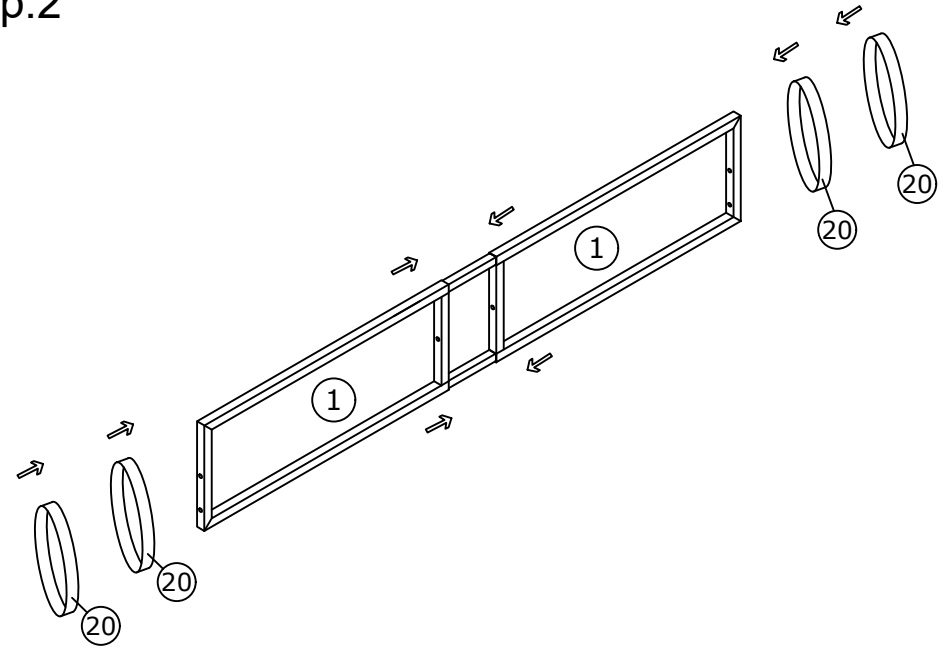

Step:2

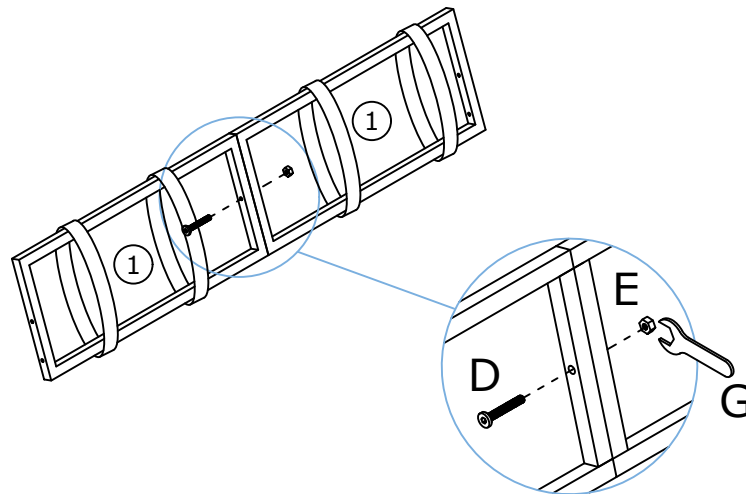

Step:3



 D. x1
M8*65

 F. x1
M8

Step:4

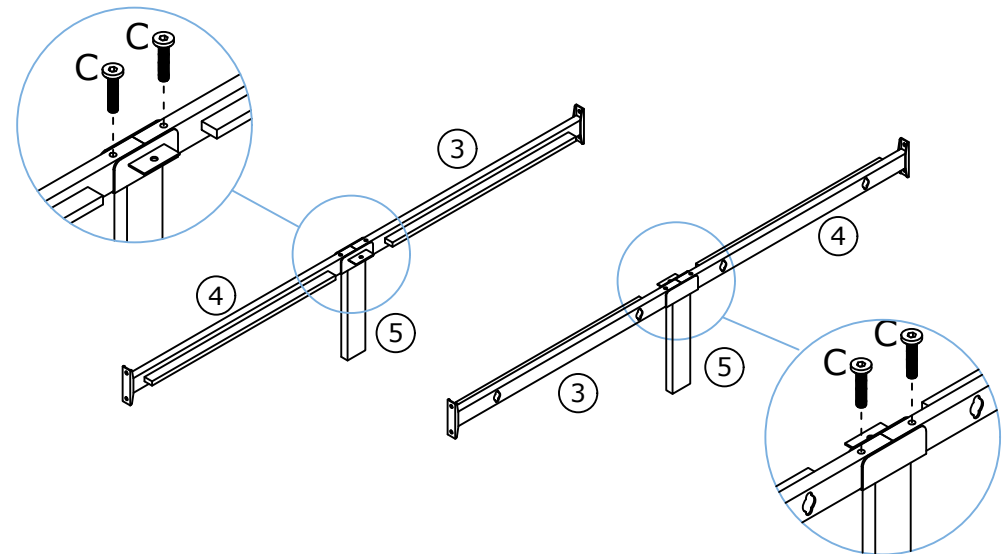

 C. x4
M8*50

MONTAGEANLEITUNG (Assembly Instructions)

Step:5

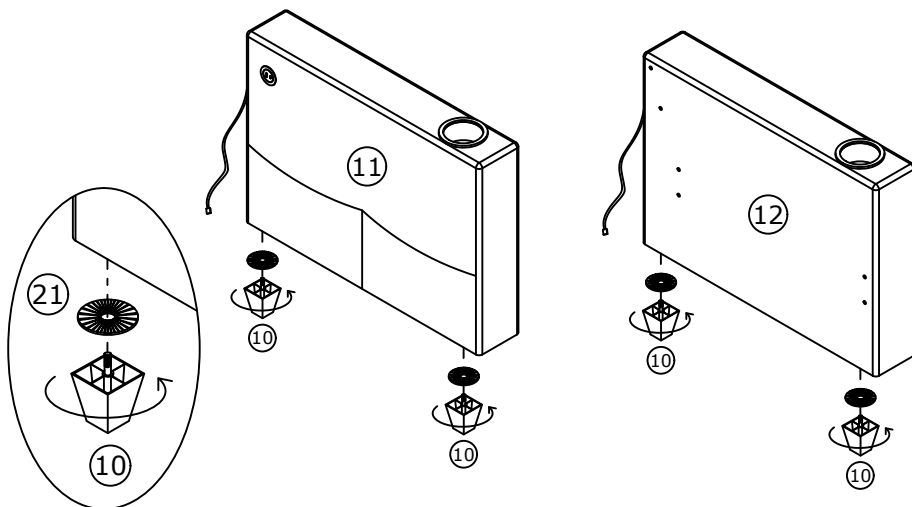

Step:6

M8*16 A. x8

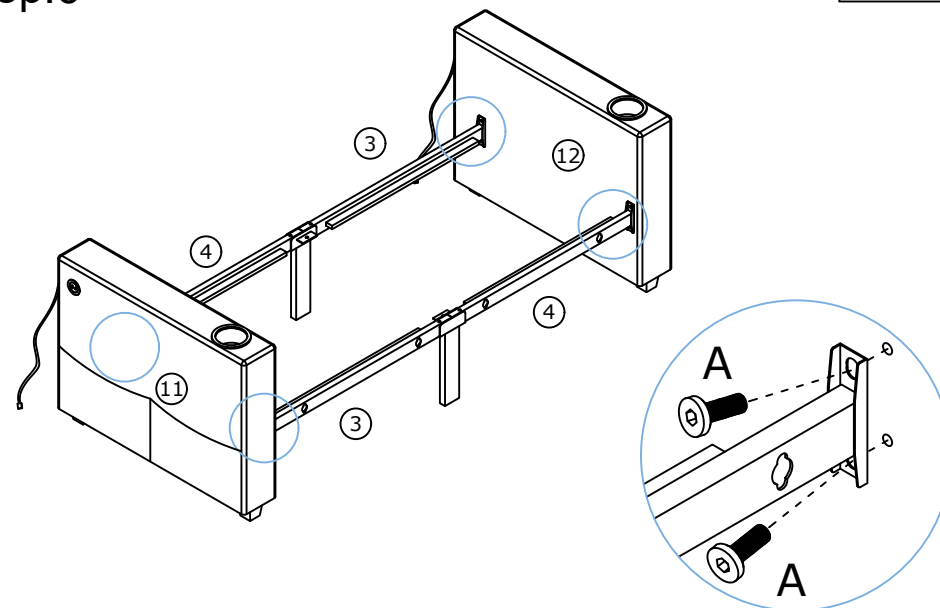

Step:7

M8*45 B. x4

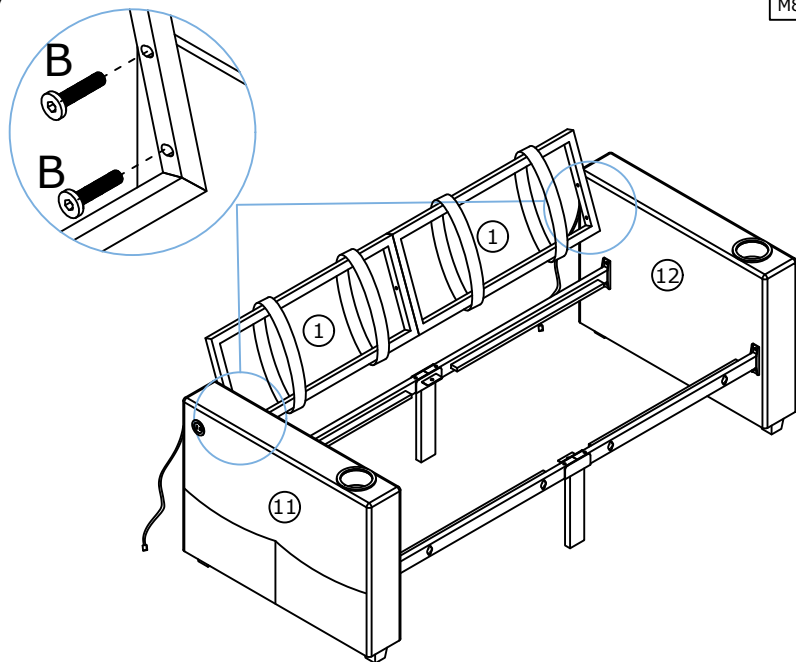

Step:8

M8*25 I. x2

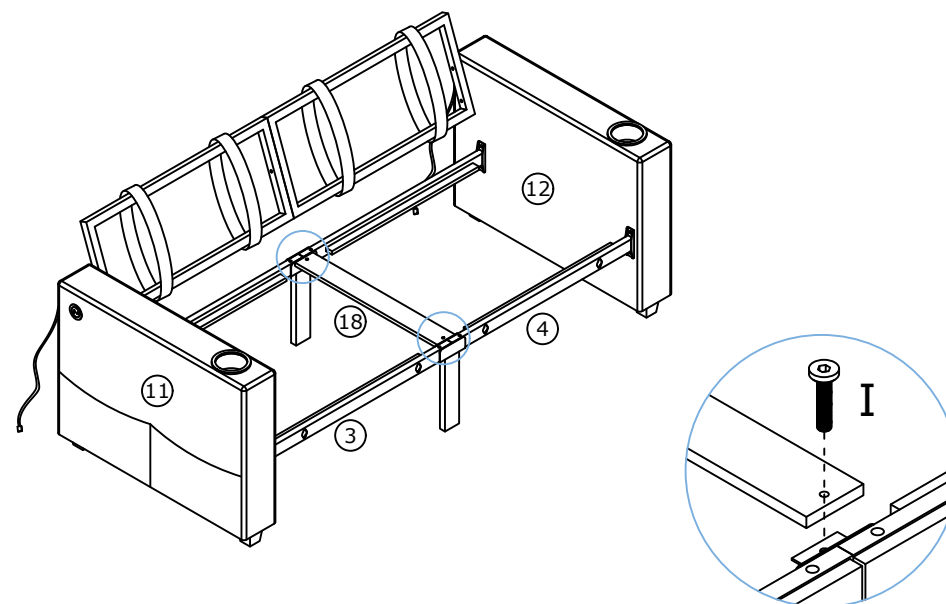

MONTAGEANLEITUNG (Assembly Instructions)

Step:9

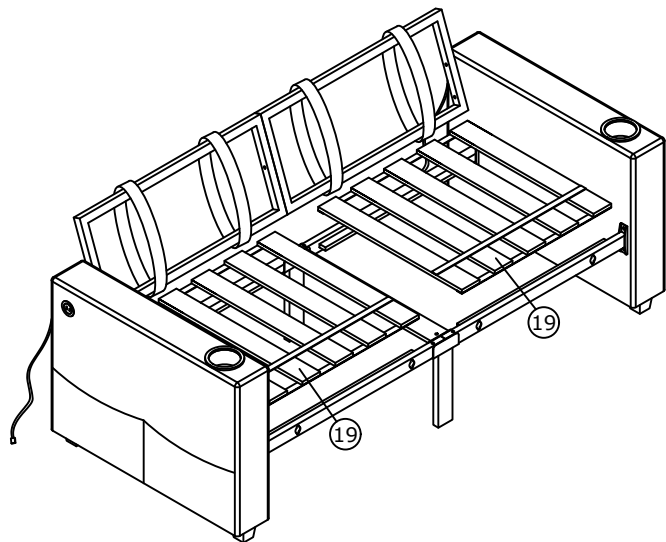

Step:10

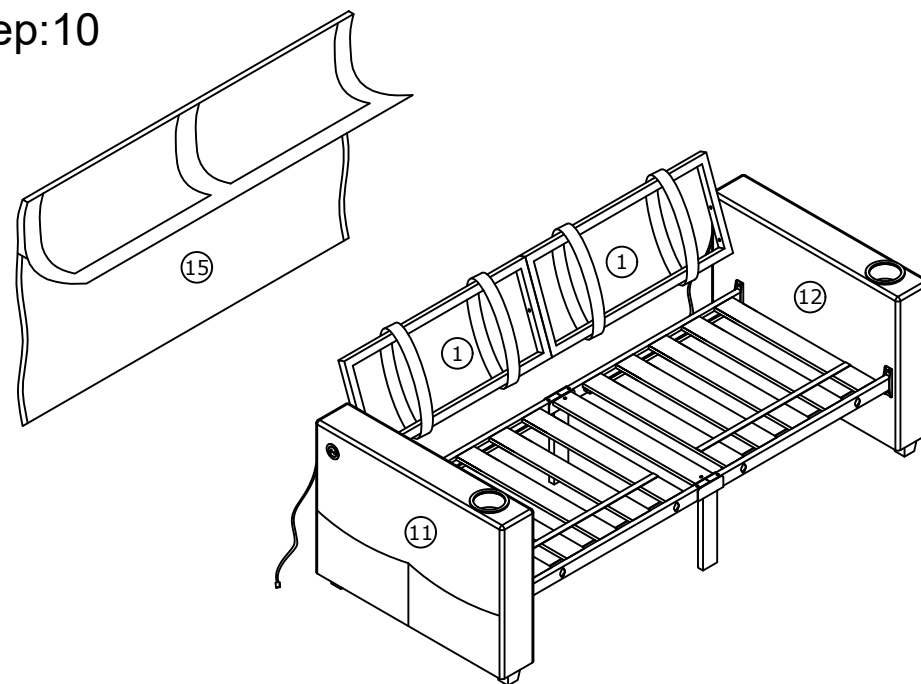

Step:11

There are also Velcro straps that come down from behind the armrest, and the fabric cover can be fully glued to the back of the armrest

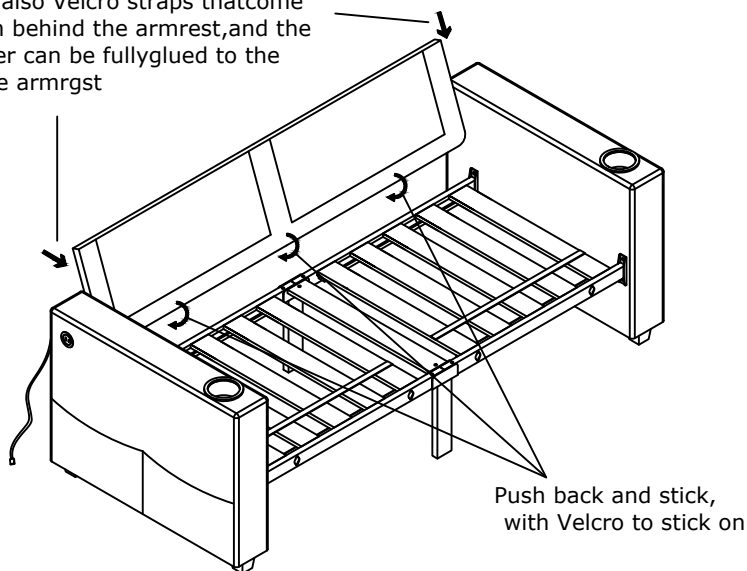

Step:12

8. x4

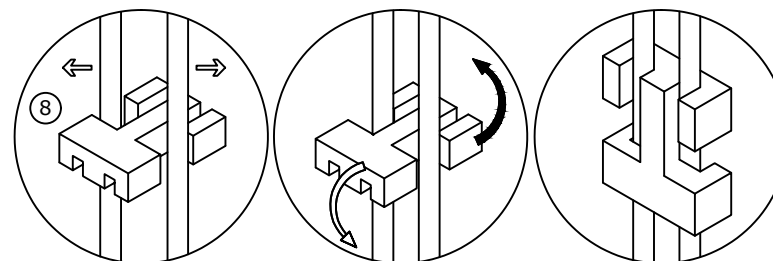
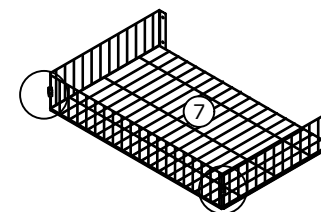

x2

MONTAGEANLEITUNG (Assembly Instructions)

Step:13

 9. x8

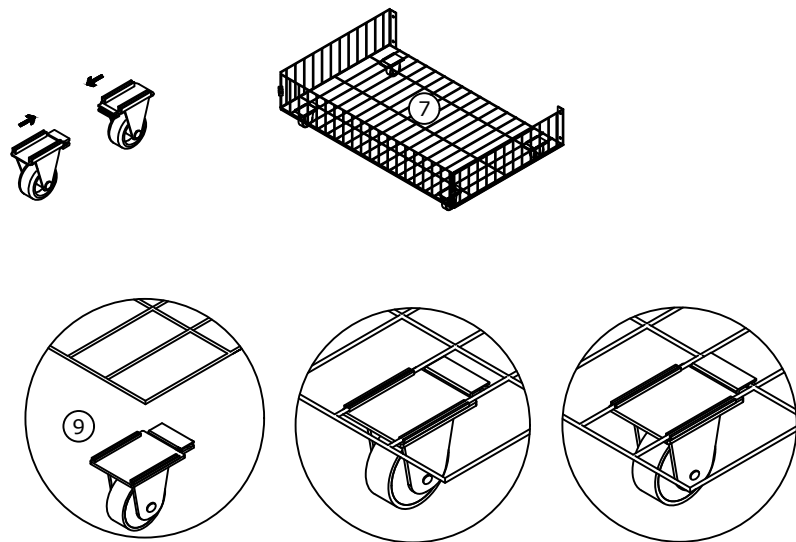

x2

Step:14

 M6*16 J. x10

 E. x4

 6. x2

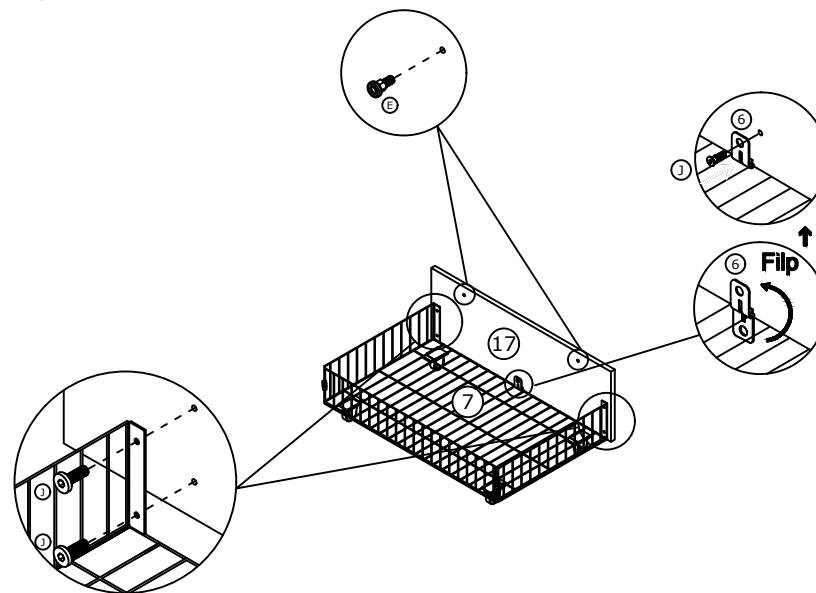

x2

Step:15

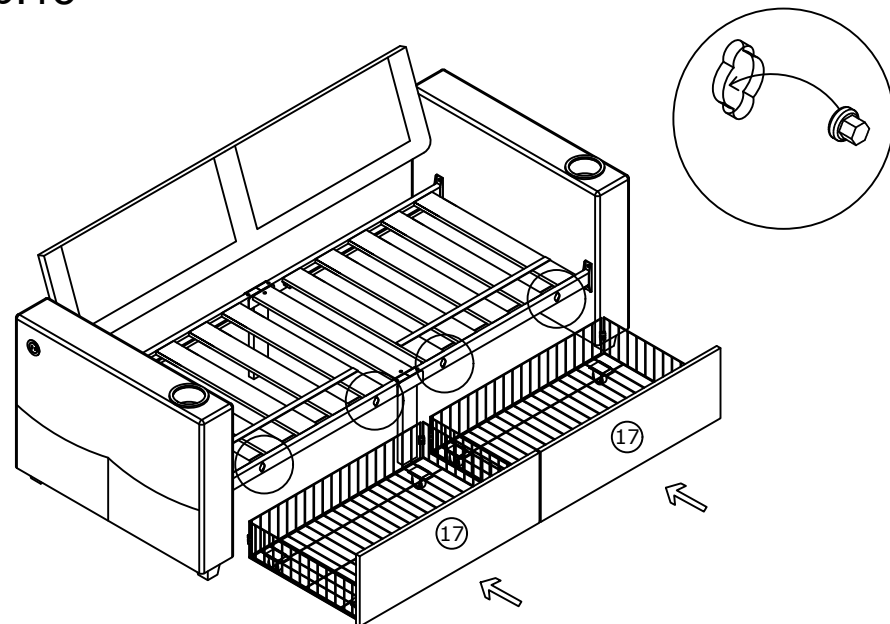

Step:16

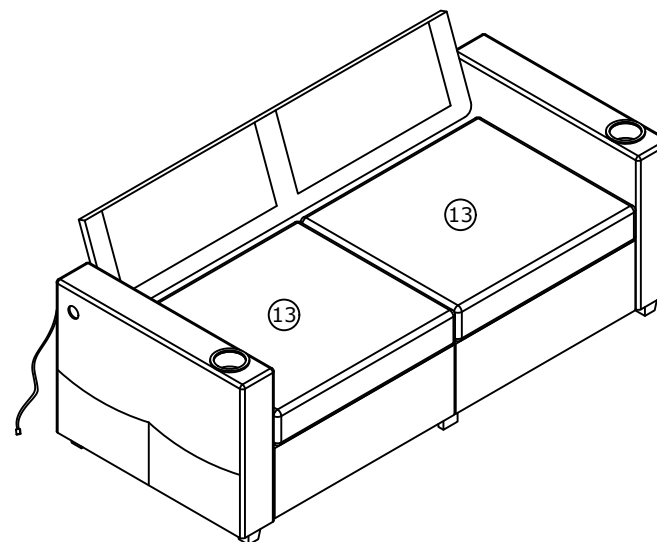

MONTAGEANLEITUNG (Assembly Instructions)

Step:17

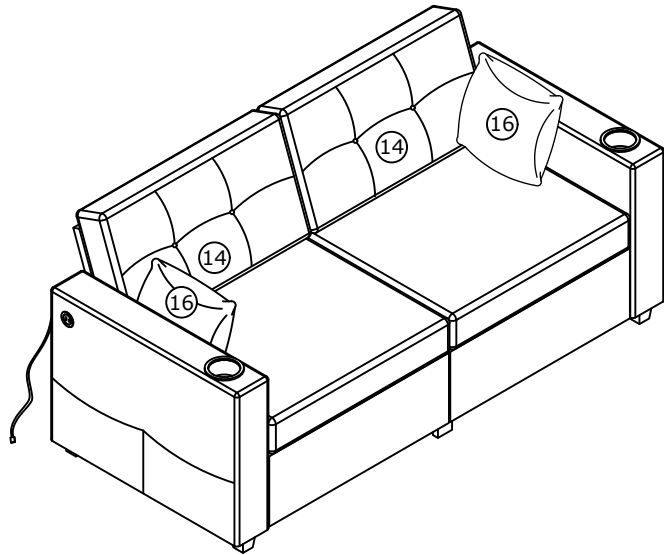

Step:18

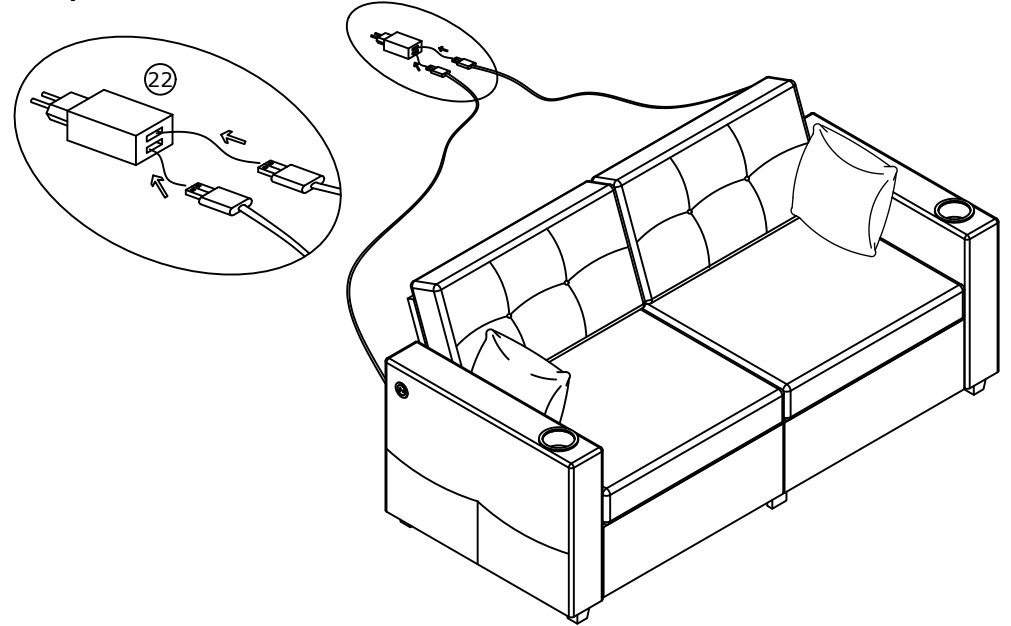

Step:19

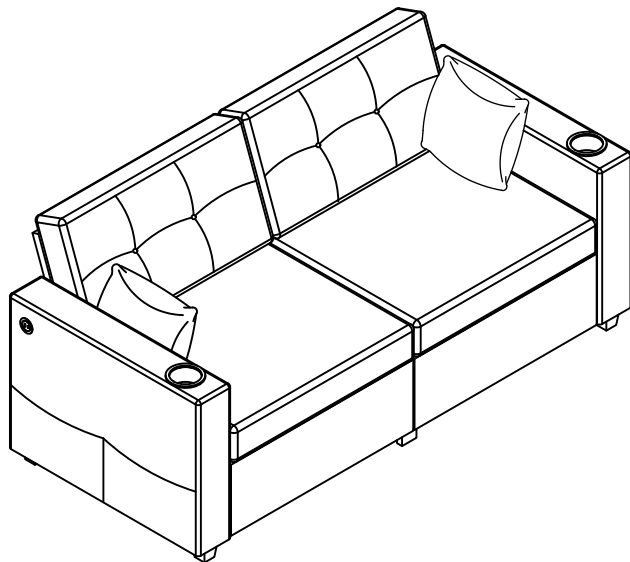

Step:20

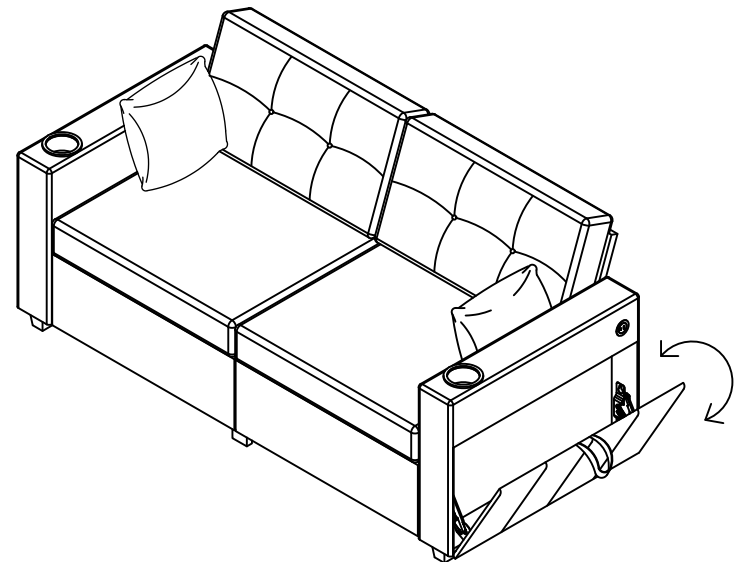

DECLARATION OF CONFORMITY

Certificate No. : RLT2508128-01

Applicant : Xiamen Laidao Optoelectronic Technology Co., Ltd.
2th Floor, No.170 , Industrial Concentration district of Tongan ,Xiamen City,
Fujian Province

Manufacturer : Xiamen Laidao Optoelectronic Technology Co., Ltd.
2th Floor, No.170 , Industrial Concentration district of Tongan ,Xiamen City,
Fujian Province

Product Name : LED strip/USB socket

Trademark : 

Main Test Model : COB0801

Additional Model : YB1708, LS0410, LS0508, LS0612, LS1004, LS1010, LS1018, LS1212,
LS1220, LS1414, ND0016, ND0020, ND0030, ND0039, COB0801,
COB1001, COB1201, COB0501, COB1401, COB0701

Test Standard : EN IEC 55015:2019+A11:2020,
EN 61547:2023

As shown in the Test Report No. : RLT2508128-01

The EUT described above has been tested by us with the listed standards and found in compliance with the council EMC directive 2014/30/EU. It is possible to use CE marking to demonstrate the compliance with this EMC Directive. The certificate applies to the tested sample above mentioned only and shall not imply an assessment of the whole production.



Daniel Wan
Manager
Aug. 15, 2025

Rhenish-Lab Certification & Testing (Shenzhen) Co., Ltd.

101, Building B, Bailu Plaza, No.48, Gonghe Industrial Road, Gonghe, Xixiang Subdistrict, Bao'an District, Shenzhen, Guangdong, China



CERTIFICATE OF CONFORMITY

Electromagnetic Compatibility (EMC) Directive 2014/30/EU

This Certificate of Conformity is hereby issued to the product designated below:

Certificate No. : 23EP06164E01
Report No. : EP2306164E01
Date Issue. : 2023-10-23
Applicant's name : SHENZHEN SUNSHINE TECHNOLOGICAL CO., LTD
Address : Room 101, Unit 3, No. 15, Dinghou Road, Dongfang Community,
Songgang Street, Baoan District, Shenzhen, China.
Manufacturer's name : Same as applicant
Address : Same as applicant
Product Description : AC/DC ADAPTER, Switching Power Supply
Model(s)/Type References : XSC-aaabbbbxyyz (aaa, bbbb, x, yy and z are variables, details see table
A for appendix)
Parameters : Input: 100-240Vac, 50/60Hz, 0.4A Max
Output: Details see table B for appendix
Standard(s) : EN 55032:2015+A11:2020+A1:2020
EN 55035:2017+A11:2020
EN IEC 61000-3-2:2019+A1:2021
EN 61000-3-3:2013+A1:2019+A2:2021

On the basis of the referenced test report(s), sample(s) tested of the above product have been found to comply with the standards harmonized with the directives listed on this verification at the time the tests were carried out. Other standards and Directives may be relevant to the product. This verification is part of the full test report(s) and should be read in conjunction with it(them).

Once compliance with all product relevant CE mark directives are verified, including any relevant e.g. risk assessment and production control, the manufacturer may indicate compliance by signing a Declaration of Conformity themselves and applying the mark to products identical to the tested sample(s).

Approved By

Eric Liu
Director of engineering department

EU DECLARATION OF CONFORMITY(No 2025.12.12)

1.Product model/product (product,type,batch or serial number):

XSC-0502000AEUU(Switch Power Adaptor)

2.Name and address of the manufacturer or his authorized representative:

Shenzhen Sunshine Technological Co.,Ltd.Room 101, Unit 3, No.15, Dinghou Road, Dongfang Community,
Songgang Street, Bao'an District, Shenzhen,China.

3.This declaration of conformity is issued under the sole responsibility of the manufacturer.

4.Shenzhen Sunshine Technological Co.,Ltd.

Object of the declaration (identification of electrical equipment allowing traceability,it may include a colour image of sufficient clarity where necessary for the identification of the electrical equipment):

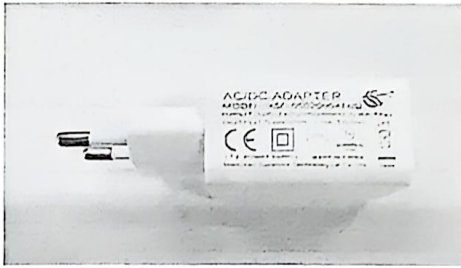

5.The object of the declaration described above is in conformity with the relevant Union harmonization legislation:

1. Low Voltage Directive(LVD)EN IEC 62368-1:2020/A11:2020

RoHS(Restriction of Hazardous Substances) Directive 2011/65/EU Annex II amending Annex(EU)20151/863 and amending Annex (EU)2017/2102

6.References to the relevant harmonized standards used or references to the other technical specifications in relation to which conformity is declared:

1.EN 55032:2015+A11:2020+A1:2020

2.EN 55035:2017+A11:2020

3.EN IEC 61000-3-2:2019+A1:2021

4.EN 61000-3-3:2013+A1:2019+A2:2021

7.Additional information:

Signed for and on behalf of:

(place and date of issue):2025.12.12

(name, function)(signature): Joy Chen

SAFETY INFORMATION OR WARNING

EN Please read carefully

Warnings:
Do not use on uneven surfaces;
Avoid climbing or tilting the product;
Check for loose screws during use;
Keep away from fires, direct sunlight, and damp environments.

DE Bitte sorgfältig lesen

Verwenden Sie das Produkt nicht auf unebenen Oberflächen;
Vermeiden Sie das Klettern oder Kippen des Produkts;
Überprüfen Sie während der Nutzung die Schrauben auf lockeren Sitz;
Von Feuer, direktem Sonnenlicht und feuchten Umgebungen fernhalten.

FR Veuillez lire attentivement

Ne pas utiliser sur des surfaces inégales;
Évitez de grimper ou d'incliner le produit;
Vérifiez les vis desserrées pendant l'utilisation;
Tenir à l'écart du feu, de la lumière directe du soleil et des environnements humides.

IT Leggere con attenzione

Non utilizzare su superfici irregolari;
Evitare di arrampicarsi o inclinare il prodotto;
Controllare durante l'uso se le viti sono allentate;
Tenere lontano da fiamme libere, luce solare diretta e ambienti umidi.

ES Por favor, lea atentamente

No usar en superficies irregulares;
Evitar subirse o inclinar el producto;
Revisar si hay tornillos sueltos durante el uso;
Mantener alejado de llamas, exposición directa al sol y lugares húmedos.